

John Deere ProGator 2030A Diesel ROPS Cab



** Shown with optional equipment

John Deere JDProGator-30 Cab

This ROPS cab is designed and built to fit:
John Deere 2030A Diesel ProGator.

Designed and built by:

Tektite Manufacturing Inc:
P.O. Box 639, 427 Buffalo Street
Winkler, MB, Canada
R6W 4A8
PH: 204-331-3463
parts@tektite.ca

One-year standard product warranty provided by Tektite Manufacturing Inc.
www.tektite.ca / www.tektitecabs.com



DO NOT PROCEED FURTHER UNTIL YOU HAVE READ THE INFORMATION BELOW.

- 1) Always wear personal protective equipment.
- 2) A minimum of two people is necessary to safely install the cab.
- 3) This ROPS cab is heavy. A lift assist device such as an overhead hoist or high lift forklift is required.
- 4) Ensure your work area is well ventilated. The installation requires the starting of the tractor which will produce dangerous carbon monoxide fumes.
- 5) Read through the entire installation manual first.
- 6) Follow the installation instructions in order.
- 7) Reading the operators manual prior to using the ROPS cab.

Tektite Manufacturing Incorporated thanks you for purchasing a John Deere ProGator ROPS cab! Tektite has worked very hard to design and build this ROPS product and we hope that it provides you with many years of protection.

Tektite's products are designed to provide safe and dependable service during operation when they are properly maintained according to the instructions. Please read this installation manual carefully before installing and using this product.

The photos/illustrations provided in this manual may not provide all the detail needed and are for reference only.

All directions provided are from the reference point of the tractor seat facing the steering wheel. All left and right references are from this viewpoint.

For reference, please fill in the information below. This will assist your dealer in providing service for this product. It is advisable that this information be provided to your insurance company as well in the event that the tractor is lost or damaged.

Vehicle Model: _____

Tektite Serial Number: _____

Date of Purchase: _____

Dealer Name: _____

Parts List Standard Cab:

Mounting Parts Bag:

Description	Qty
Bolt, Hex, 5/8" x 3", Gr. 8, YD	4
Structural Washer, 1/4" thick	4
Nut, Flange, 5/8", Gr. 8, YD	4
Bolt, Flange, 3/8" x 1 1/2", YD, Gr. 8, FULL THREAD	6
Nut, Flange, 3/8", YD, Gr. 8	6
Bolt, Hex, 1/2" x 4 1/2", Gr. 8	2
Wire Loop, 1/4"	2
Wire Loop, 3/8"	2
Zip Ties, Standard	8

Loose Components:

Description	Qty
Chassis Isolator, Rubber, 5/8" (pre-install)	4
Rear Mounting Brackets	L&R
Front Mounting Brackets	L&R
Floor mat, operator platform	1

Optional Heater Kit Parts List (DIESEL ONLY)

Description	Qty
Straight fitting, 3/8NPT x 3/8" barb	2
Washer, Flat, 16MM ID, Brass	2
Sensor Adapter, 16MM, Straight Port (pressure)	1
HS-6 hose clamps	2
5/8" ID heater hose (total length)	22' total
3/8" ID heater hose (total length)	4' total, looped together at end of 5/8" hose.

Optional Air Conditioner Kit Parts List (2030A Only)

Description	Qty
Alternator Mounting Bracket	1
Compressor, REAR Port (2 ears removed)	1
Compressor Tensioner Bracket	1
Alternator Tensioner Bracket	1
Main Drive Belt 31/64" x 40 3/8"	1
Alternator Drive Belt 1/2" x 22" (4L220W)	1
Nut, Flange, M10	3
Bolt, Flange, M10 x 100, FULL THREAD, Gr. 8.8	2
Bolt, Flange, M10 x 50, YD	1
Tube Spacer, 11/32" CRITICAL LENGTH	1
Tube Spacer, 1 – 3/16" CRITICAL LENGTH	1
Flange Nut, 3/8"	2
Flange Bolt, 3/8" x 1 1/2"	1
Hex Bolt, 3/8" x 1"	1
Female Bullet Connector	1

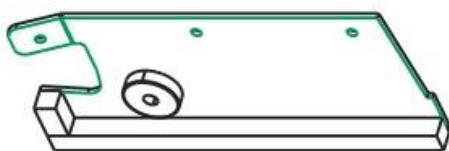

Left Front
Bracket

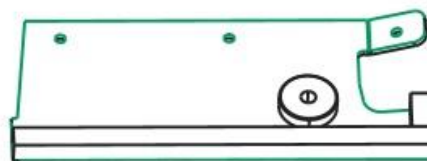

Right Front
Bracket

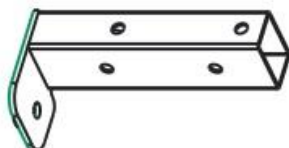

Left Rear
Bracket

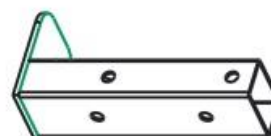

Right Rear
Bracket

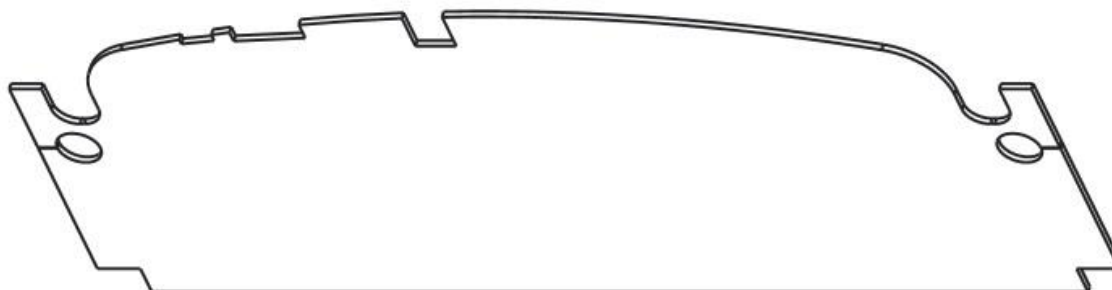

Platform
Floormat

Air-Conditioner Parts ONLY



Alternator
Mount
Bracket



Compressor
Tensioner



Alternator
Tensioner



Long Tube
Spacer 1-3/16"

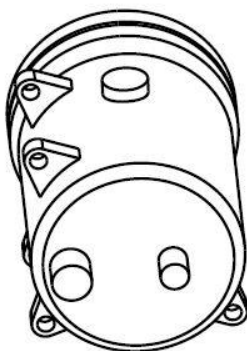

Rear Port Compressor
w/two ears removed



Short Tube
Spacer 11/32"

Air Conditioner Installation Instructions:

Compressor mounting can occur before the cab is installed.

- Disconnect the battery.
- Un-hook the alternator plug and remove the main power ring connector.
- Un-bolt and remove the alternator tensioner bracket (save fasteners).
- Un-bolt and remove the alternator (save fasteners).
- Un-bolt the engine lift ear.



- Drain the engine coolant.
- Locate the engine coolant hose shown at the top of the thermostat and remove the hose.
- The alignment procedure is as follows, compressor ear, **11/32"** spacer, gear case, **1 – 3/16"** spacer, compressor ear, front to back. Fasten the compressor to the ear on the gear-case block that the alternator was originally fastened to with the provided M10 x 100 Full Thread bolt. Gear case is threaded, so take your time while installing. Once bolt has emerged from the opposite end of the compressor ear, use the M10 flange nut provided to start fastener. **DO NOT OVERTIGHTEN any fasteners that attach to the aluminum body compressor. WILL CAUSE LEAKS.**

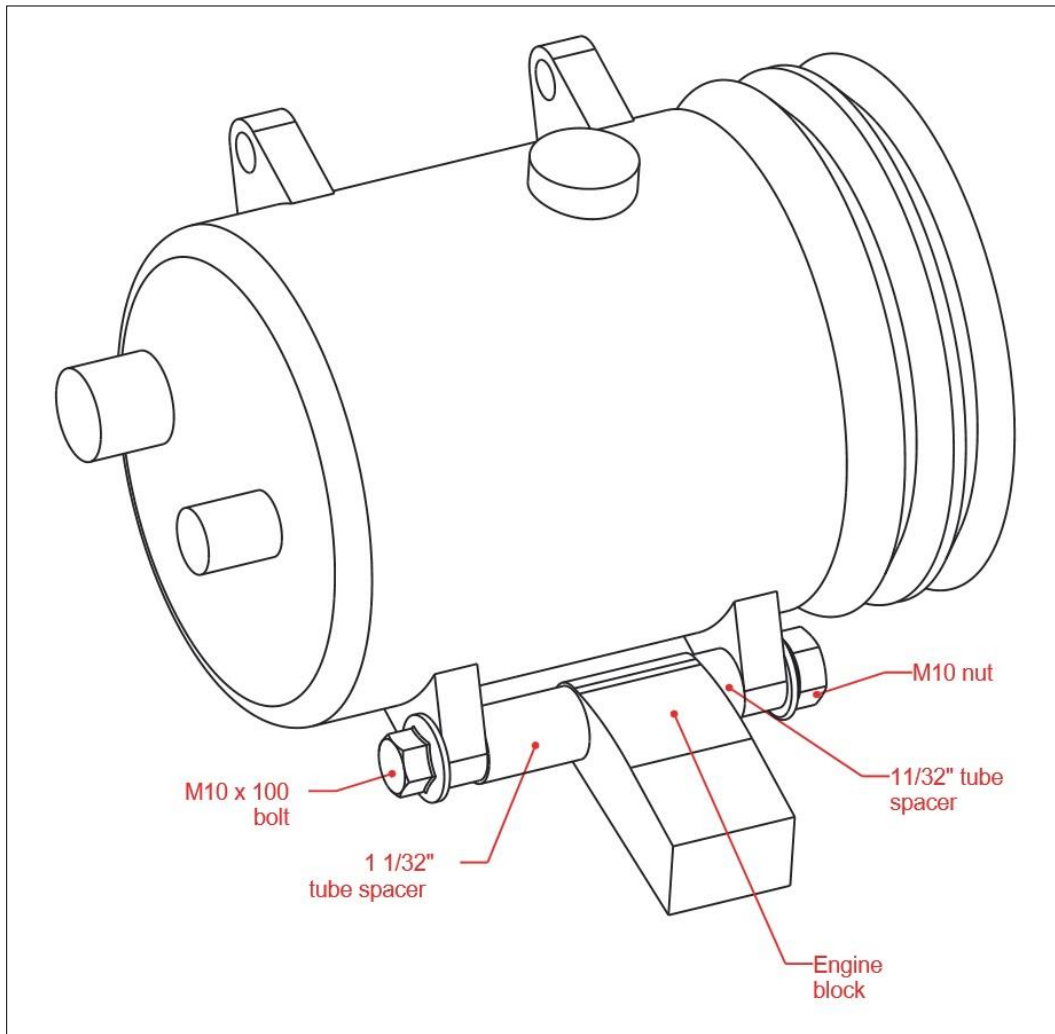

- Remove the main engine drive belt by un-bolting the fastening yoke on the main crank pulley.
- Take the new longer drive belt, 31/64" x 40 3/8" and slip through the bottom crank pulley, around the water pump pulley, and then over in the inside compressor pulley. **PLEASE NOTE: The pulley is VERY tight and will be difficult to fit over the compressor pulley. It is designed to be tight at the start.**
- Take the provided compressor tensioner and re-using factory alternator tensioner bolt fastener, bolt the tensioner to the engine in the same location as the original alternator tensioner. Note the location of the fill port hole, the two ears that are removed go tight to the engine.

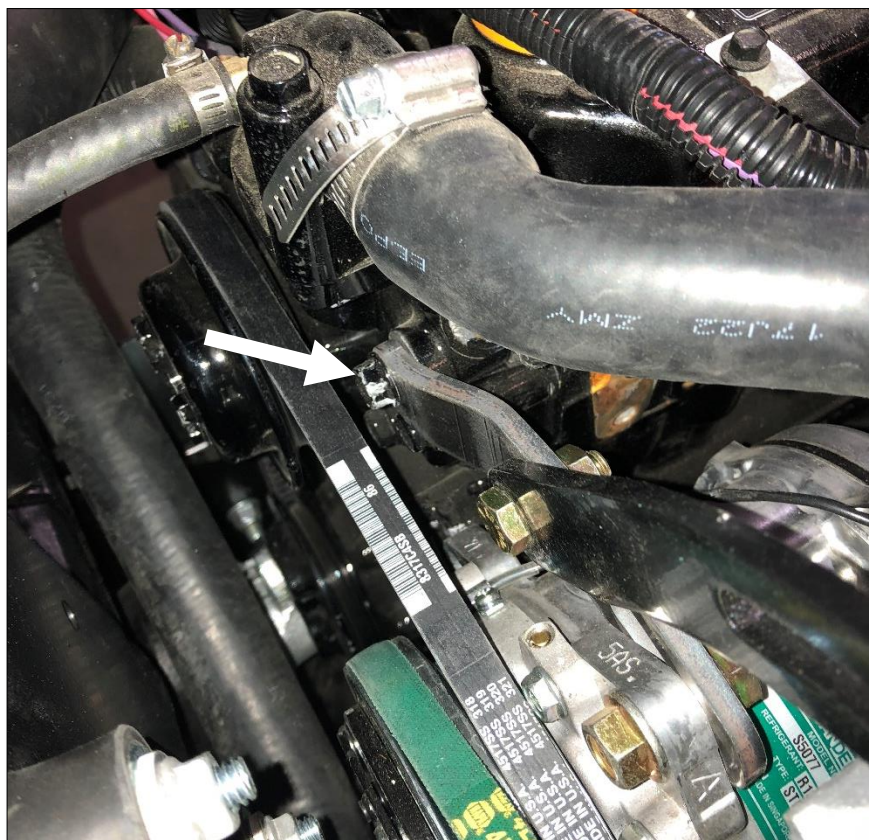

- Take the provided 3/8" x 1 1/2" flange bolt and nut and fasten the tensioner bracket to the compressor. **DO NOT OVERTIGHTEN any fasteners that attach to the aluminum body compressor. WILL CAUSE LEAKS.**

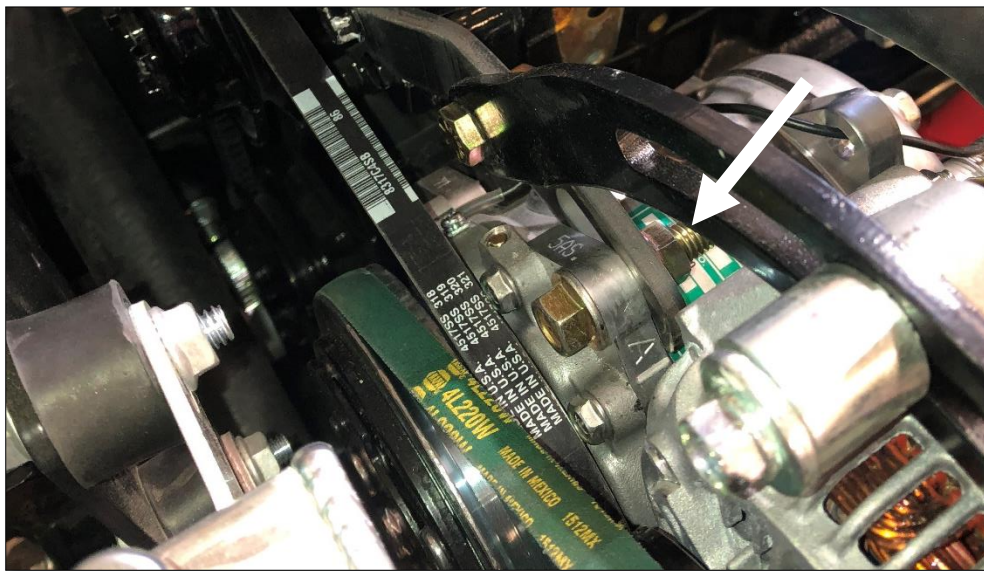

- Take the provided alternator mounting bracket and bolt to the compressor ears as shown. Use the provided M10 x 100 flange bolt, and nut. The bracket tube will extend past by $\frac{1}{4}$ " unlike the photo shown. **DO NOT OVERTIGHTEN any fasteners that attach to the aluminum body compressor. WILL CAUSE LEAKS.**



- Take the alternator and then fasten to the mounting bracket installed earlier. Use the provided M10 x 50 flange bolt and nut.

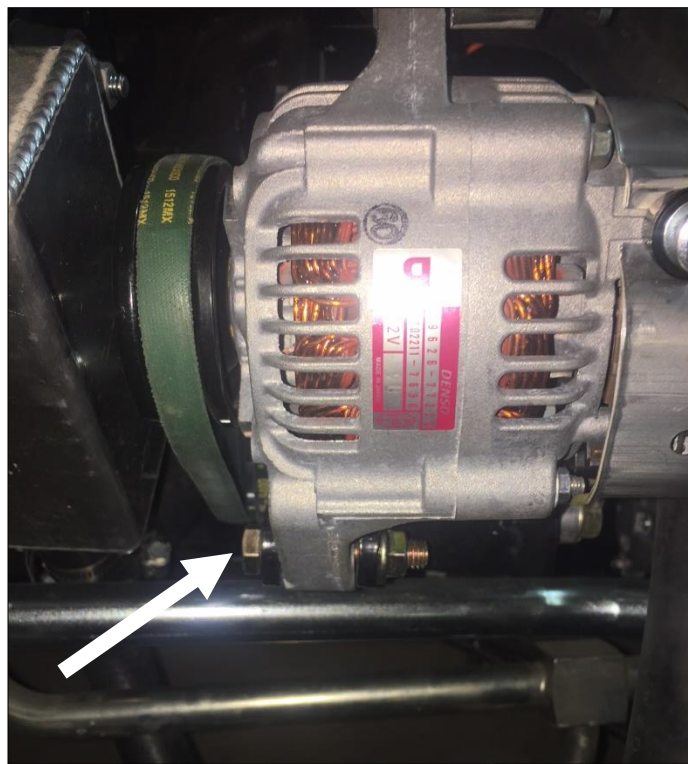

- Slip the short alternator belt, 1/2" x 22" over the front compressor pulley and onto the alternator.

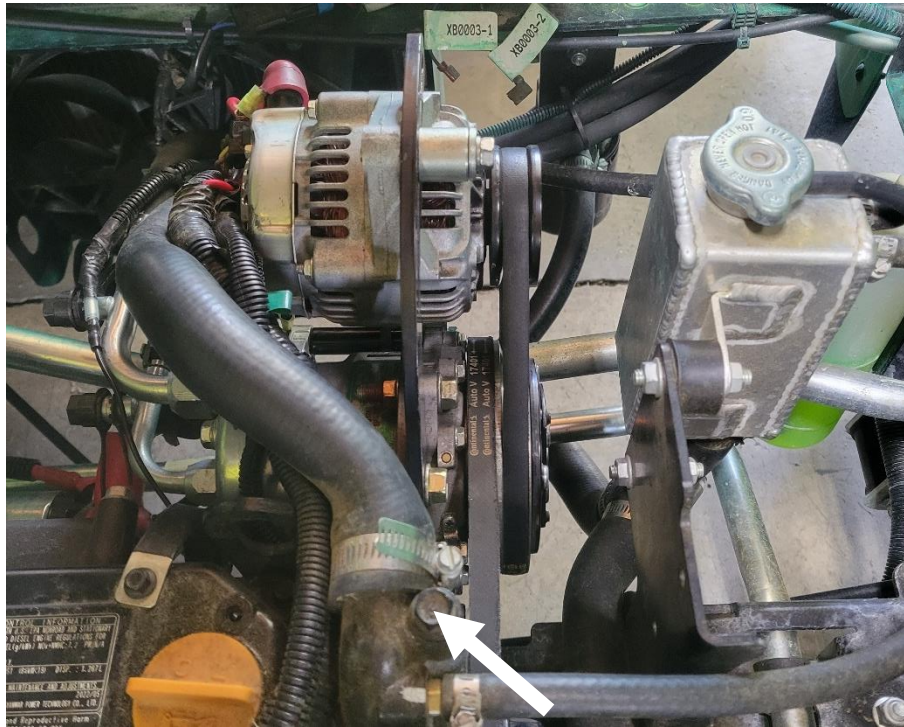

- Take the provided alternator tensioner bracket and fasten to the compressor tensioner bracket with the provided 3/8" x 1" hex bolt and nut. **DO NOT OVERTIGHTEN** any fasteners that attach to the aluminum body compressor. **WILL CAUSE LEAKS.**

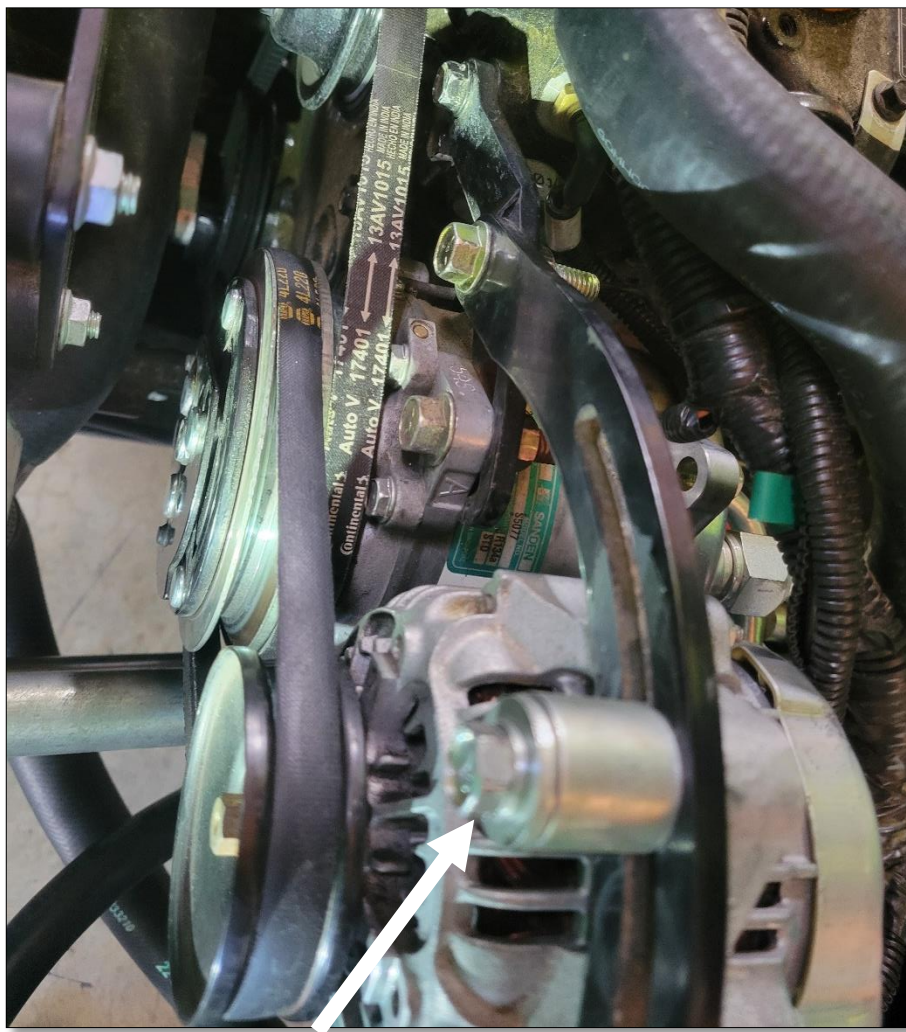

- Apply tension to the belt and tighten the tensioner to the alternator with the factory hardware. **DO NOT OVERTIGHTEN any fasteners that attach to the aluminum body compressor. WILL CAUSE LEAKS.**
- Take the upper radiator hose and re-install around the alternator as shown.

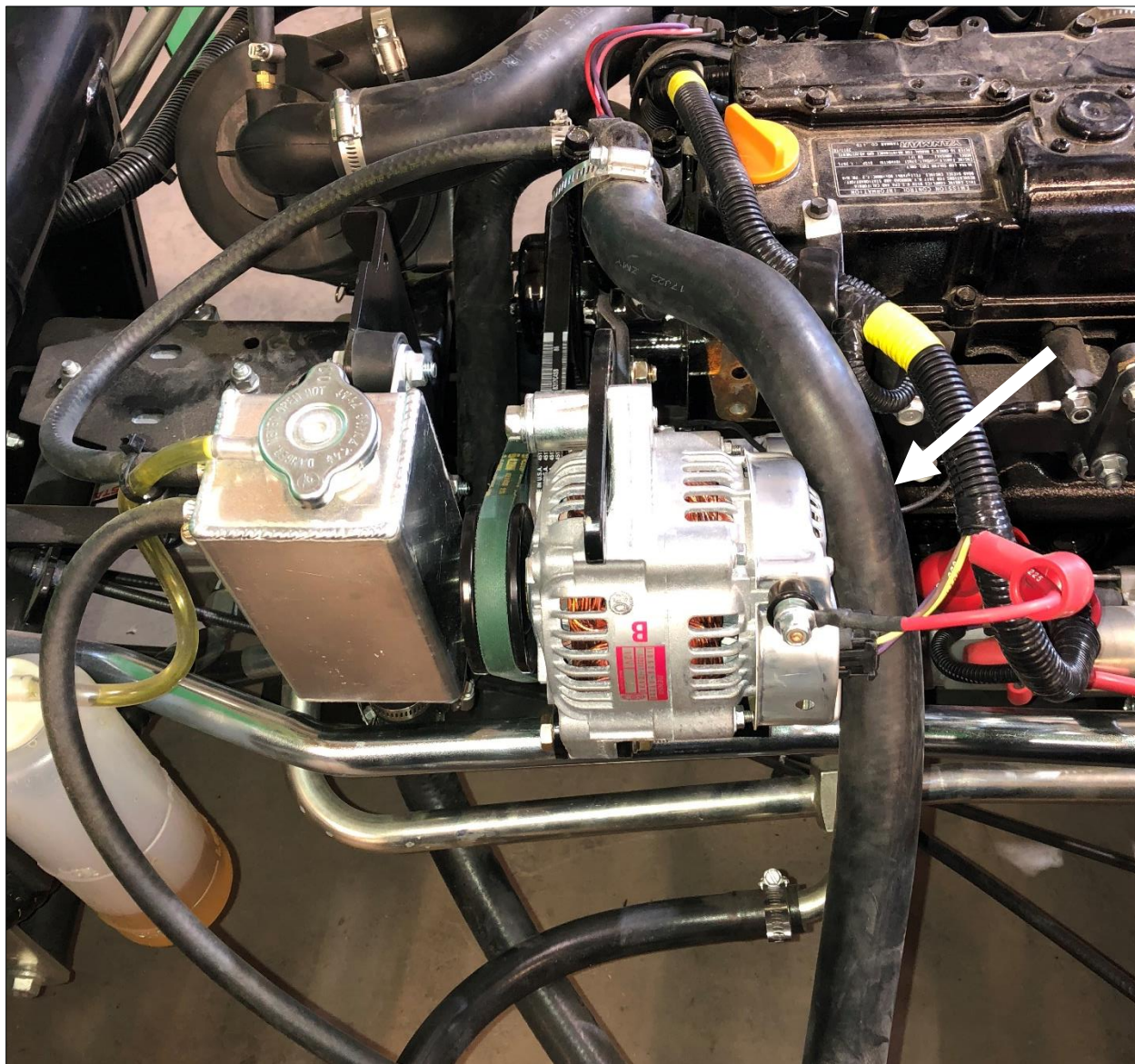

- Locate the starter and loosen the main power connector. Rotate the connector so that is now vertical or facing tight to the engine.

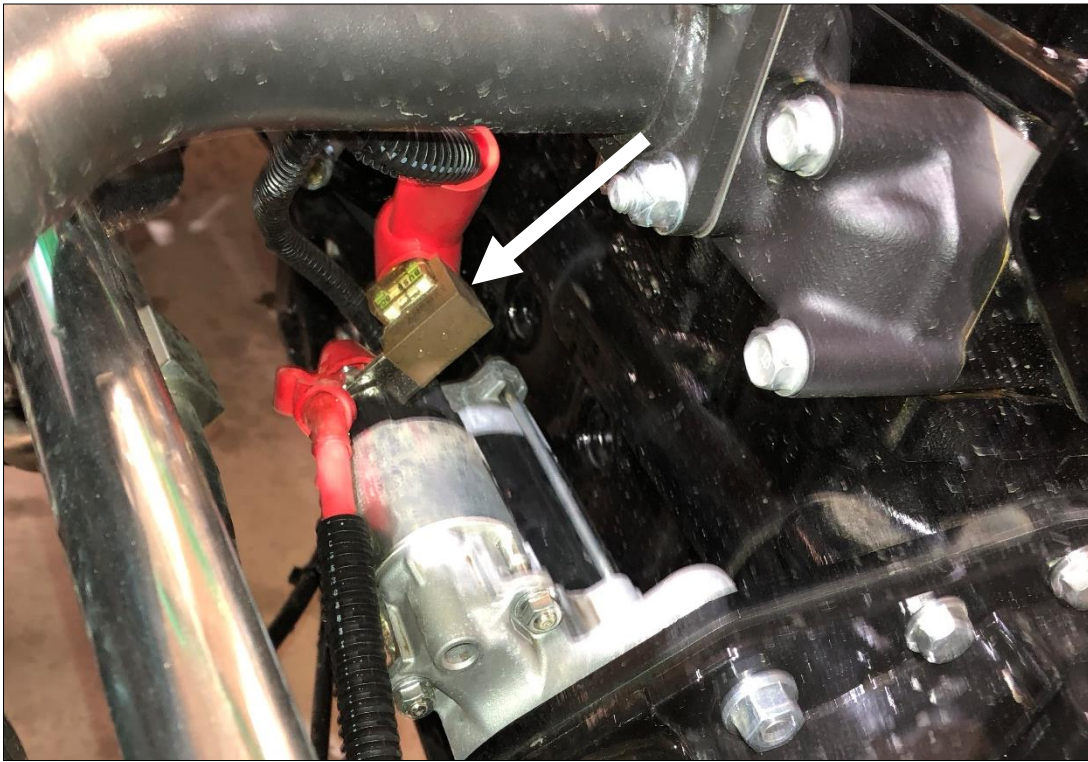

- Locate the harness coming off of the starter and going to the alternator. It can now stretch and connect to the alternator. If necessary, loosen the wire loom.

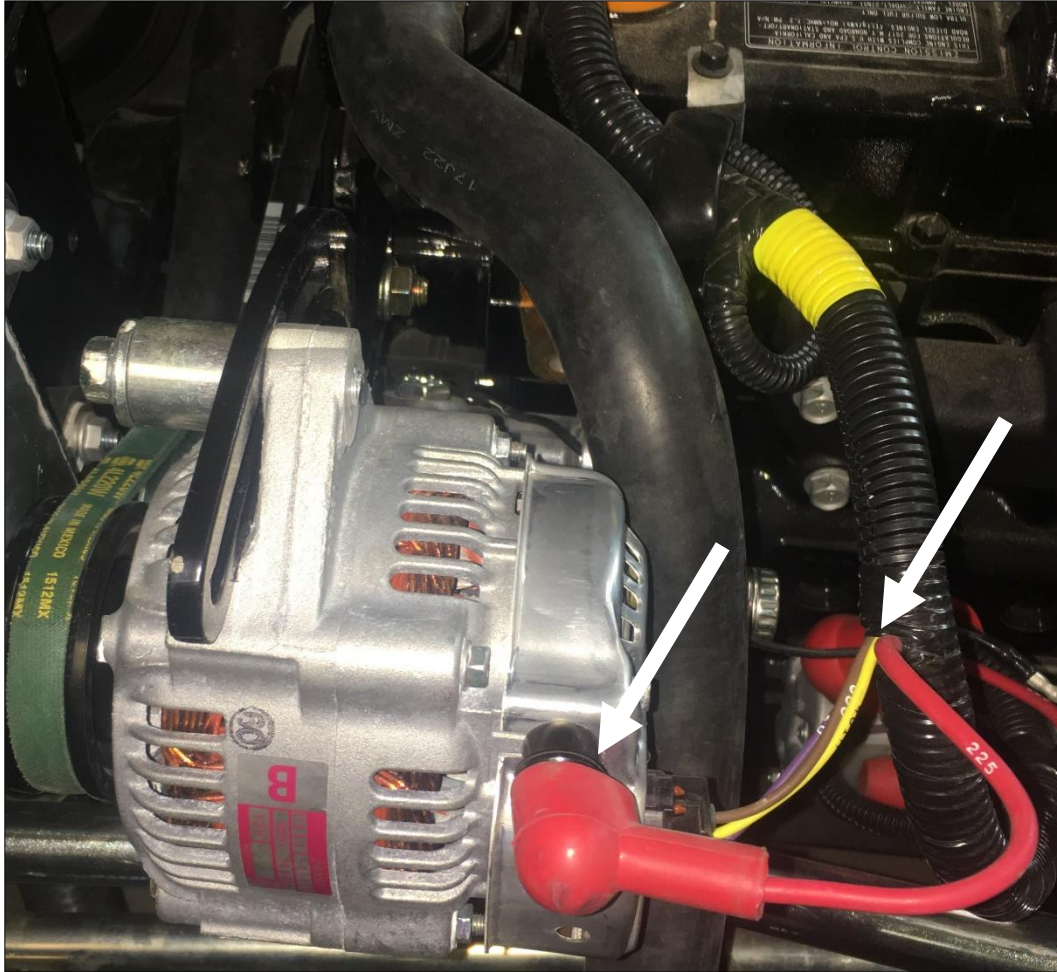

- Re-connect the alternator and re-connect the battery.

The balance of air conditioner install will be completed after the cab is installed.

Standard Cab Installation Instructions:

1. Remove the two-post ROPS from the machine. Save fasteners to be re-used later.
2. Take the left rear mounting bracket and slide it into the 2-post ROPS socket. Use the ROPS fasteners removed earlier, and bolt the bracket into place.



3. Repeat for the right rear mounting bracket.
4. Remove the front bolt shown in the operator foot platform on the left and right sides.
5. Take the left front bracket and position onto platform. Use provided 3/8" x 1 1/2" flange bolts and nuts. Bolt the existing hole in the place, align the bracket carefully so that it sits parallel to machine centerline, and then make and drill the remaining two holes to 7/16" diameter. Use the 3/8" x 1 1/2" flange bolts and nuts for the remaining fasteners.



6. Repeat for the right front bracket.

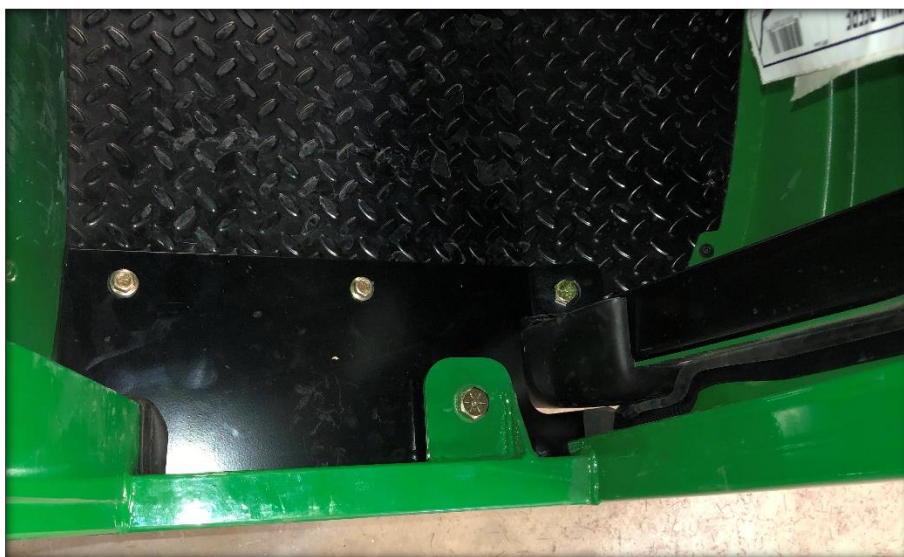

7. Return to the cab to install lift brackets next. To remove the gas shock on the left cab door, slide a flat screwdriver underneath the small clip on the end cap that must be pulled UP order to pop the shock off of the ball stud. **The shock will release very easily when this is accomplished.** Lift the door assembly straight up and off of the cab and put aside for now.



8. Take one of the $\frac{1}{2}$ " x 4 $\frac{1}{2}$ " hex bolts and fasten to the weld nut lift tab located at the top of the door b-post. Repeat for the other side.

9. Take a lifting strap or chain, and connect both lift bolts to an over-head hoist or forklift.

10. Carefully un-bolt the cab from the rear shipping brackets and front shipping fasteners and then lift cab up off of the shipping pallet.

11. Raise the cab over the machine. Use **soapy water** on the hood shield weather-stripping to make it slide over the front cowl easier, **it is a very tight fit**. Slowly lower straight down onto the machine.



12. For the front and rear isolator fasteners, use the provided 5/8" x 3" hex bolt, heavy 1/4" thick flat washer, and flange nut. Loosely start all fasteners first, do not torque any until they are all started. Lower cab down until there is slack on the lift brackets.

13. As soon as all fasteners are started, remove lift brackets.

14. Apply final torques as follows. For 5/8" fasteners, use 205 ft-lbs, for M12 fasteners use 88 ft-lbs, for 3/8" fasteners use 50 ft-lbs. Tighten brackets and isolator fasteners.

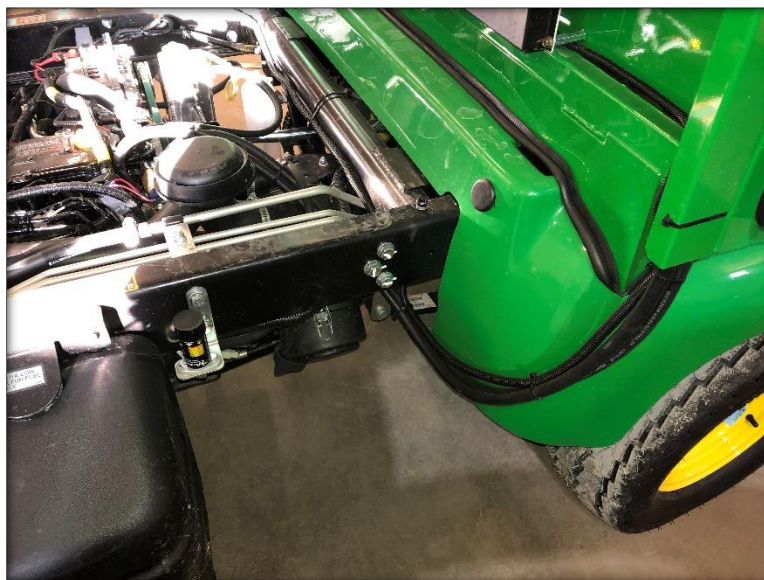

15. Route the electrical harness from the cab underneath the chassis rails and into the engine bay. Connect the 10GA black wire to a ground bolt on the alternator. Use provided 1/4" loop, shorten wire if necessary, then solder connector to black wire. Connect the 10GA red wire to a constant 12V source on the alternator. Use provided 1/4" loop, shorten wire if necessary, then solder connector to the red wire. Connect the orange wire to a switched source on the alternator (yellow wire), solder direct.

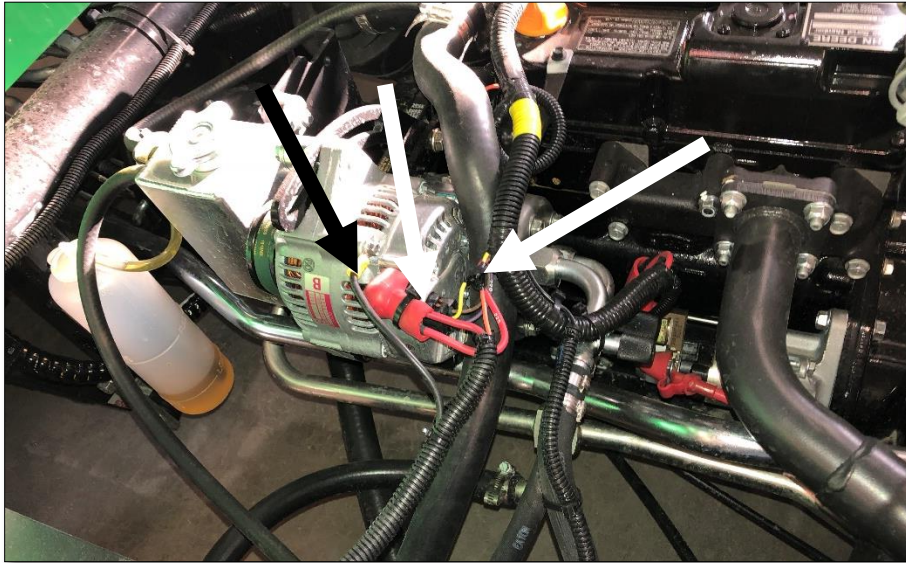

Proceed with steps 16 to 22 if cab is equipped with heater option.

NOTE: The pressure hose is on the left side of the cab. The suction hose is on the right side.

For 2030A models, use steps 16 to 22. For 2020A models, use steps 23 to 26.

16. Drain the engine antifreeze.

17. Locate the thermostat sending unit and remove, this will become PRESSURE. There is a plug right beside it on a horizontal plane, remove it as well, it will become SUCTION. Use a Teflon tape around the threads of all fittings. THIS IS FOR 2030A models only!

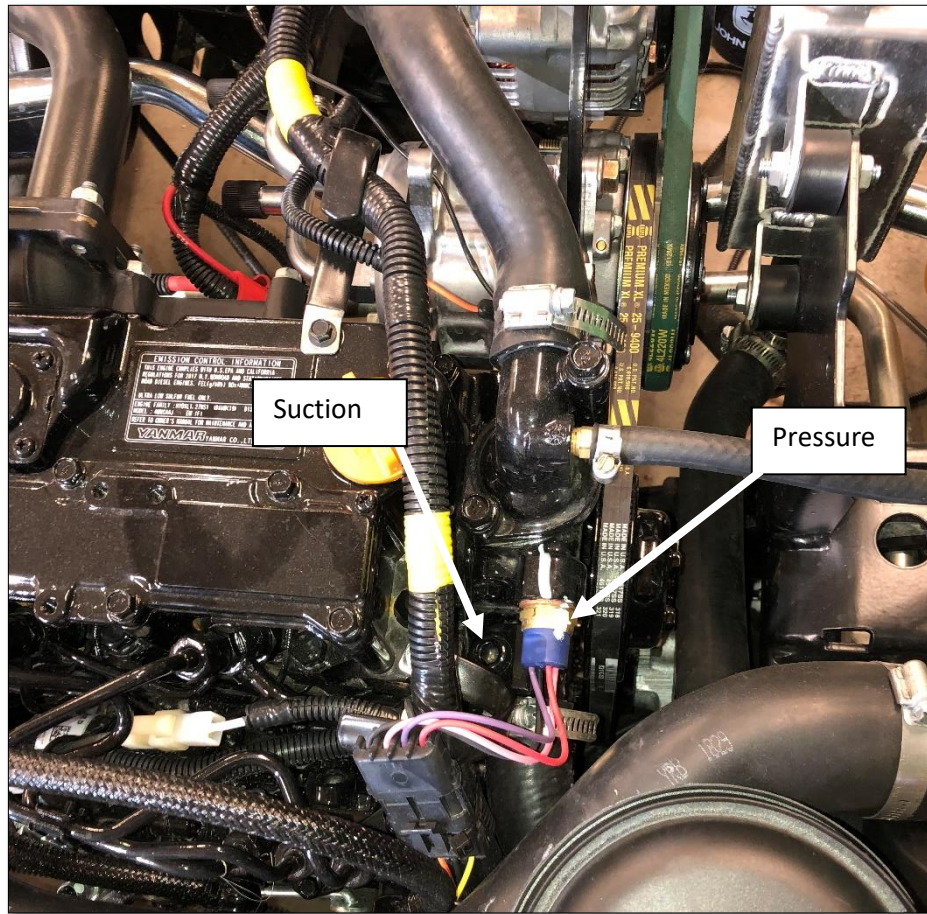

18. Take the provided 3/8NPT x 3/8" barb straight fitting and install into the location where the plug was located, SUCTION fitting. THIS IS FOR 2030A models only!

19. Take the provided sensor adapter and install into location where thermostat sending unit was located. Install sending unit in-line with fitting. Install remaining 3/8NPT x 3/8" barb fitting PRESSURE, into other open spot on adapter. THIS IS FOR 2030A models only!

Use provided flat washers as needed to ensure proper tightness of heater fittings to minimize chance of coolant leaks.

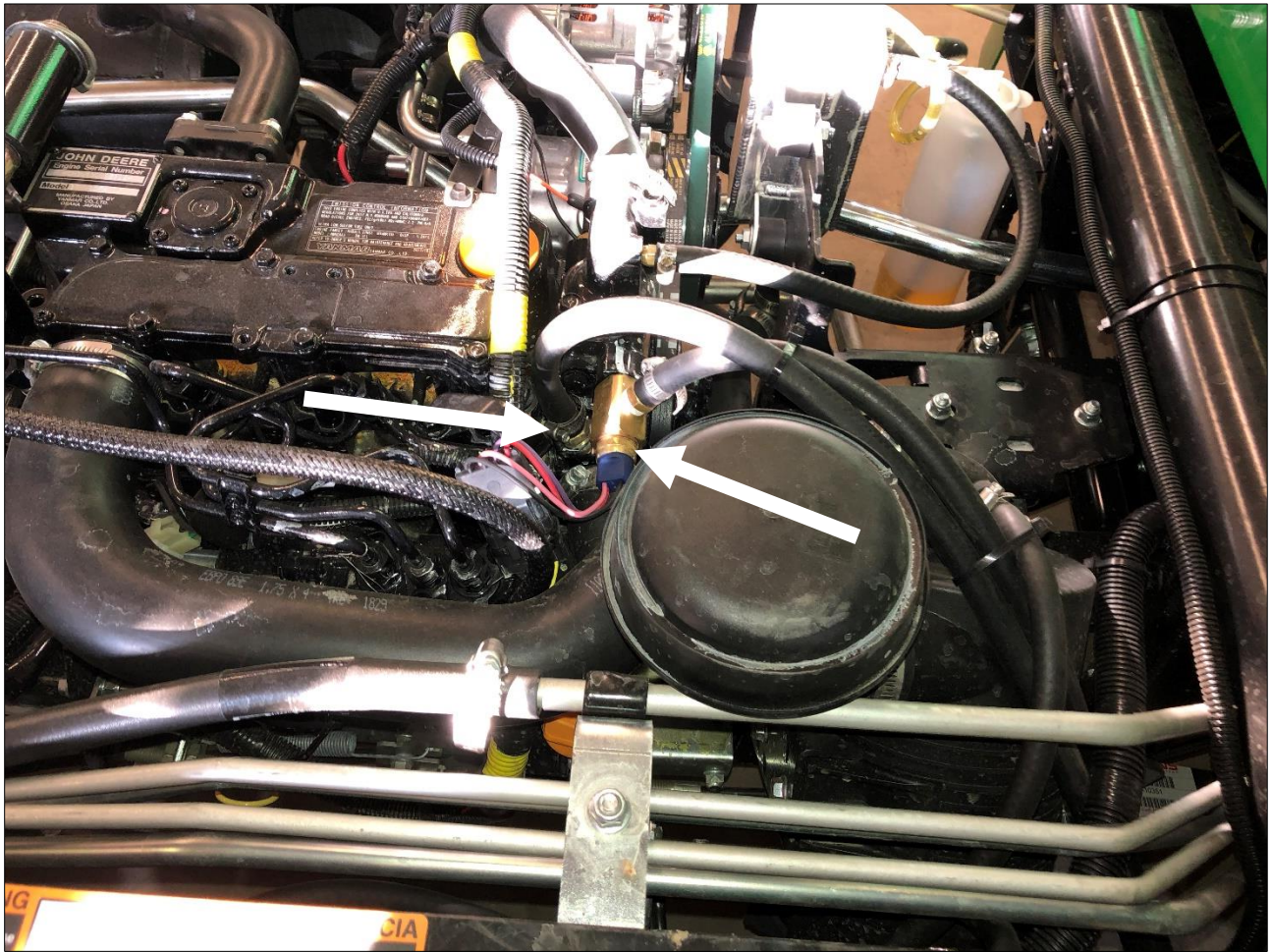

20. Route the heater hoses from the cab underneath the chassis rails and into the engine bay. Take the pressure side hose on the cab (LEFT) and connect to the PRESSURE fitting installed either. Use the provided HS-6 hose clamp to attach. THIS IS FOR 2030A models only!

21. Route the remaining heater hose to the SUCTION fitting. Use the provided HS-6 hose clamp to attach. THIS IS FOR 2030A models only!

22. Use the provided zip ties to fasten the hoses into place and prevent them from interfering with moving parts on the engine.

For 2020A models:

23. Drain the engine antifreeze.

24. Locate the lower radiator hose and cut out a short section 1 ½" long. Install the provided 1" barbed Tee fitting and use provided clamps to secure into place.

25. Take the provided 1/2FPT brass fitting and install into Tee. **BE SURE to use a silicone sealant around the threads of the fitting to prevent water leaks!** This is the SUCTION port. Use a Teflon tape around the threads of all fittings. THIS IS FOR 2020A models only!



26. Locate the thermostat and remove. Install the provided street tee fitting. **BE SURE to use a silicone sealant around the threads of the fittings to prevent water leaks!** Re-install the thermostat onto the inline side of the tee fitting. Take the provided 1/4NPT x 3/8" barb straight fitting and install it into the open fitting at right angle. This is the PRESSURE port.

Use provided flat washers as needed to ensure proper tightness of heater fittings to minimize chance of coolant leaks.

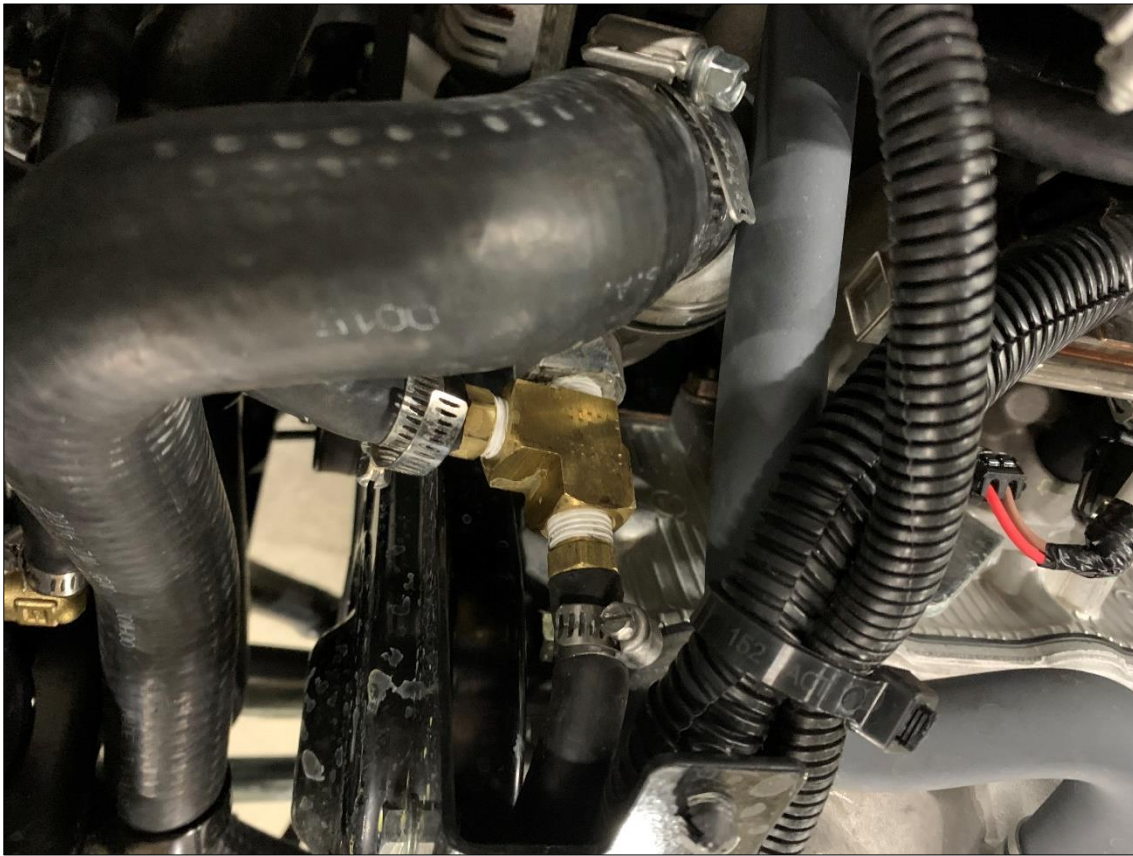

27. Route the heater hoses from the cab underneath the chassis rails and into the engine bay. Take the pressure side hose on the cab (LEFT) and connect to the PRESSURE fitting installed either. Use the provided HS-6 hose clamp to attach.

28. Route the remaining heater hose to the SUCTION fitting. Use the provided HS-6 hose clamp to attach.

29. Use the provided zip ties to fasten the hoses into place and prevent them from interfering with moving parts on the engine.

30. Make sure all fitting connections are tight and the hoses are properly secured to the machine. Re-fill the engine antifreeze. Go to the cab, and turn the heater control switch to the maximum heat side. Start the engine and turn the cab fan to the highest speed setting. Take the radiator cap off of the engine and place a funnel into the radiator. Fill the funnel with antifreeze. The engine will need to run for a few minutes and the thermostat open a few times in order for all air to be purged from the heater system. The air at the cab louvers should be very hot when that occurs. NOTE: ensure adequate fresh air ventilation in the work space you are in, carbon monoxide from the engine exhaust is deadly.

31. Take the platform floormat and position onto floor board. Ensure that the pedals have full range of motion, notch if necessary. Glue into place with an aerosol glue, 3M high strength 90 is recommended.



32. To ensure a better seal of all weather stripping and floor mat pieces, it is recommended that you use a black silicone seal to seal the cab parts to the tractor.

Air conditioning installation continued.

- Take the air conditioning hoses from the cab and route into the engine bay under the chassis rails.



- Connect the # 10 hose to the #10 fitting on the compressor. Ensure that the o-ring is properly seated. Use the provided zip ties, and zip the hoses to the vehicle to keep from hot surfaces and moving parts.
- Connect the # 8 hose to the # 8 fitting on the compressor. Ensure that the o-ring is properly seated. Use the provided zip ties and zip the hoses to the vehicle to keep from hot surfaces and moving parts.
- Ensure that once the fittings are installed, they do not interfere with the gear shift linkage.

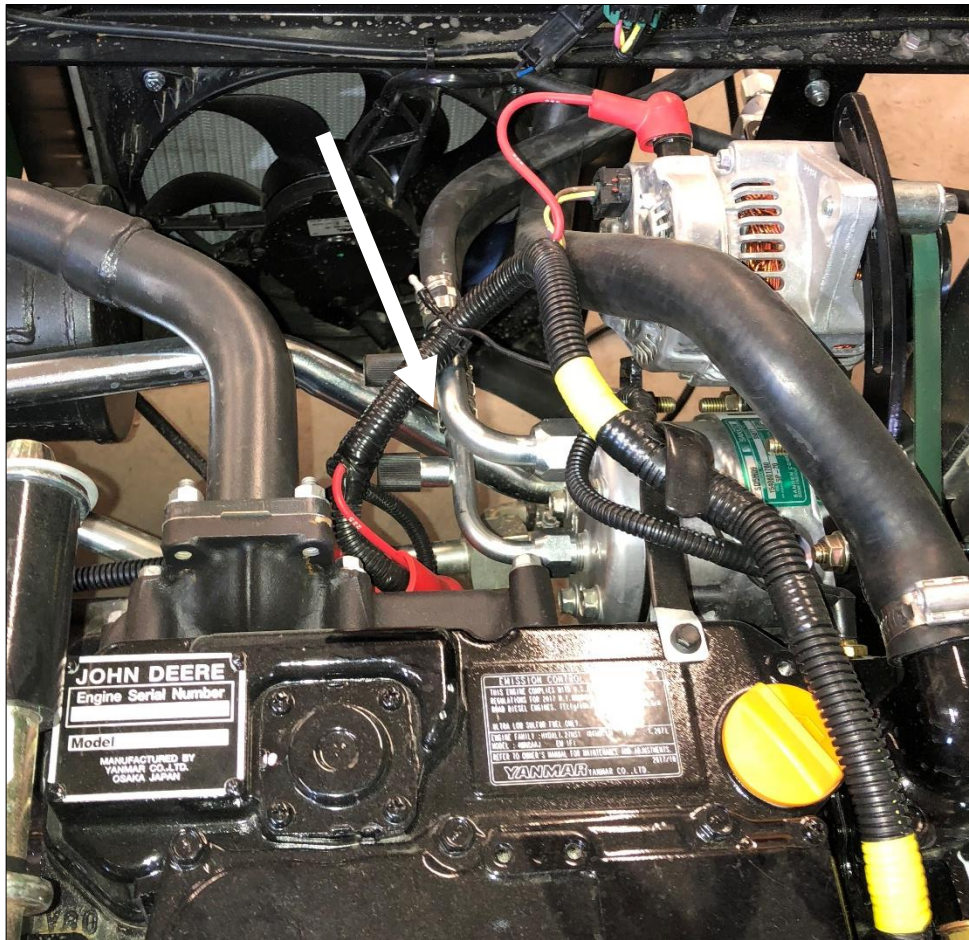

- Take the white wire with the hoses and route to the compressor clutch activation wire on the compressor. Shorten wire if necessary. Take the provided female bullet connector and crimp onto the end of the white wire.
- Connect the two bullet connectors together.
- Take the provided zip ties and tidy up the hoses running into the engine. Use ties as necessary.
- The air conditioner is now ready to be charged. A licensed air conditioner installed **MUST** perform the install. The compressor is pre-filled with oil. The air conditioning system is designed to use 2 lbs of R134a coolant.
- **DO NOT OVERTIGHTEN any fasteners that attach to the aluminum body compressor. WILL CAUSE LEAKS.**

John Deere ProGator ROPS Cab



** Shown with optional equipment

John Deere JDProGator-01 or JDProGator-30 Cabs

These ROPS cabs are designed and built to fit either:
John Deere ProGator 2020A Gas or 2030A Diesel

Designed and built by:

Tektite Manufacturing Inc:

P.O. Box 639, 427 Buffalo Street

Winkler, MB, Canada

R6W 4A8

PH: 204-331-3463

parts@tektite.ca

One-year standard product warranty provided by Tektite Manufacturing Inc.

www.tektite.ca / www.tektitecabs.com



DO NOT PROCEED FURTHER UNTIL YOU HAVE READ THE INFORMATION BELOW.

- 1) Always wear personal protective equipment.
- 2) A minimum of two people is necessary to safely install the cab.
- 3) This ROPS cab is heavy. A lift assist device such as an overhead hoist or high lift forklift is required.
- 4) Ensure your work area is well ventilated. The installation requires the starting of the tractor which will produce dangerous carbon monoxide fumes.
- 5) Read through the entire installation manual first.
- 6) Follow the installation instructions in order.
- 7) Reading the operators manual prior to using the ROPS cab.

Tektite Limited Warranty

Tektite Manufacturing Inc. ("Tektite") warrants to the original purchaser (the "Claimant"), that Tektite products will be free from defective materials or workmanship, under normal use and service, for a period of (1) full year from the original invoice date. Tektite's liability under this Limited Warranty is limited to the repair or (at the discretion of Tektite) the replacement of those components of its products, which were manufactured by Tektite that are defective in materials or workmanship. Tektite shall have no liability under this Limited Warranty unless Tektite is notified of the defect during the stated Warranty Period.

Limitations and Exclusions: Tektite has no responsibility to a Claimant under this Limited Warranty or on any other basis for any of the following:

- a) defects caused, in whole or in part, by accident or misuse, negligence or failure to maintain the product or component;
- b) products or components sold to a customer on an "as is" basis;
- c) wiper blades, light bulbs, fuses, clear vinyl or other consumables;
- d) glass where the point of failure has not been preserved intact and delivered to Tektite for analysis of the cause of the failure;
- e) products or components which have been modified after shipping from Tektite to its customer;
- f) transportation charges for returned, repaired or replacement items;
- g) defects that are subject of a Tektite initiated recall where the Claimant fails to comply with the terms of the recall notice that comes to the attention of the Claimant;
- h) components of Tektite products that are manufactured by third parties (Tektite's only obligation in relation to such components shall be to accord to the Claimant the benefit of any transferable warranty accorded to Tektite by third party manufacturer);
- i) defects in workmanship or materials in products or components that are repaired or replaced by Tektite unless Tektite is notified of the new defect within the Warranty Period that applied to the original product or component that has been repaired or replaced;
- j) defects that result, in whole or in part, from inadequate engineering or specifications provided to Tektite by its customer;
- k) any actual or alleged deficiency in technical or engineering services or advice provided by Tektite to its customer whether provided for valuable consideration or otherwise;
- l) consequential damages, or any other damages whether foreseeable or not, resulting from the defect or any delay in remedying the defect;
- m) any breach or alleged breach of any implied warranty of merchantability or fitness for particular purpose of use;
- n) defects or part failure due to misuse or failure to follow recommended cab installation procedures; and
- o) travel expenses, including mileage.

This Limited Warranty expresses the entire obligation of Tektite, its officers, directors, agents and employees, to its customer or any Claimant in respect of any defect in workmanship, or materials of any product or component sold or manufactured by Tektite whether on grounds of breach of contract, negligence or other tortious liability, breach of express or implied warranty or other basis in law of any jurisdiction.

Acceptance by a customer of delivery of products of Tektite constitutes acceptance of this Limited Warranty in lieu of all other warranties express or implied including without limitation all implied warranties of merchantability or fitness for particular purpose or use and constitutes acceptance by customer of the exclusions and limitations of the liability of Tektite set out above. Once received, the cab should have ALL exterior cardboard, Styrofoam wrapping removed for immediate inspection of product to ensure that no damages have occurred during transportation. Outer coverings should stay off the cab and the cab be stored indoors in a controlled environment. The warranty card must be completed and returned to Tektite.

Warranty claims should be reported to parts@tektite.ca. A warranty claim form and instructions will be provided at this time. Warranty work not pre-authorized by Tektite may not be covered by this warranty agreement. Labor rate and time allowances are fixed by Tektite. Approved warranty claims will be issued in the form of credits applied to customer account.

Safety Precautions

Safety First

Read these instructions carefully. It is essential that you read the instructions and safety regulations before you attempt to assemble or use the features that are on this cab/ROPS.

Danger: Indicates an immediate hazardous situation which, if not avoided, will result in death or serious injury.

Warning: Indicates a potentially hazardous situation which, if not avoided, may result in death or serious injury.

Caution: Indicates a potentially hazardous situation which, if not avoided, may result in minor or moderate injury.

Important: Indicates that cab or property damage may result if instructions are not carefully followed.

NOTE: All products are designed to give safe, dependable service if they are operated and maintained according to instructions. It is the owner's responsibility to be certain anyone operating this product reads this manual, and all other applicable manuals, to become familiar with this cab and all safety precautions. Failure to do so could result in serious personal injury or cab damage. If you have any questions, consult your dealer. Read and understand this manual before operation.

NOTE: A safe operator is the best assurance against accidents. All operators, no matter how experienced they may be, should read this operator manual and all other related manuals before attempting to operate features in this cab/ROPS and operate the base tractor. Please read the following section and pay particular attention to all safety recommendations contained in this manual and those labelled on the cab and on the tractor.

General Safety

1. Never let an unqualified or untrained driver operate the tractor.
2. Keep a fire extinguisher, with ABC rating securely fastened in the ROPS. Maintain it and be familiar with its use.
3. Do not carry passengers.
4. Never operate the tractor in a closed building for a prolonged period. Ensure adequate ventilation is present, as engine exhaust fumes are poisonous and can kill.
5. Always keep sleeves, jackets or other loose clothing relatively tight and belted. Loose clothing may catch on moving parts and result in severe personal injury or death.
6. Provide a first-aid kit, securely attached inside of the ROPS for use in case of accident.
7. Never jump from the tractor. There is a danger of tripping or falling on protruding parts.
8. Use steps and hand holds when mounting and dismounting the tractor, or for servicing components too high to reach from the ground.
9. When seated in the ROPS, fasten seat belt before starting the engine. A proper seat belt must be worn at all times when using a ROPS.
10. Safety devices and shields are intended to protect operators from injury or death. Under no circumstances should they be modified, disabled or removed.

Operating Safety

1. Always operate the tractor controls while sitting in the operator's seat.
2. Lock seat in position and buckle seat belt before operating the tractor.
3. Avoid abrupt sharp turns at high speeds.
4. On sloped terrain, do not make sharp turns as machine stability could be compromised.
5. Operate the tractor smoothly, avoid abrupt starts and stops.
6. Keep all shields in place when operating the tractor.
7. Do not operate the tractor when you are tired, sick, or impaired.
8. Never operate the tractor in confined areas; visibility next to the tractor is reduced. Injury to bystanders or damage to the ROPS or equipment may result.

Safety

Carefully review the procedures given in this manual and the tractor operator's manual with all operators annually. It is important that all operators become familiar with, and follow safety precautions. Operating instructions must be given to everyone using the tractor before operation and at least once yearly thereafter in compliance with OSHA Regulations 1928.57 (United States).

Safe Operation on Rough Terrain

1. Drive the tractor slowly on hillsides and curves to eliminate the danger of tipping. Avoid slopes which are too steep for safe operation. Avoid sharp uphill turns.
2. Always drive slowly enough over rough ground or obstructions. Drive at speeds slow enough to ensure your safety.
3. When driving out of a ditch, gully, or up a steep hillside, engage the clutch slowly. Avoid sharp uphill turns.
4. When descending steep grades, select a sufficiently low gear to maintain control with minimum use of braking.
5. Use caution when driving near the edge of a ditch or gully. It may cave in, causing the tractor to roll over.
6. Be alert when operating near trees, slopes and around obstructions. Tree branches can cause damage to ROPS components.

Maintenance Safety

1. Remove mud, crop residue, chains, and tools from steps and operator's platform. They may interfere with pedal operation or entry/exit from tractor.
2. When servicing components are too high to reach from the ground use steps and handholds. Do not use fenders or shields that are not designed as steps.

Safe Highway Operation

1. Before operating the tractor on, or near, public roadways check with your local authorities for any local regulations that will affect you.
2. Equip towed implements with slow moving vehicle (SMV) signs when traveling on public roads.
3. Install additional lights on implement rear to safeguard against rear end collisions.
4. Use hazard warning flashers as required by law when transporting or driving on public roads. If the tractor had warning flashers removed when mounting the ROPS, they must be replaced prior to operation on public roads.
5. Keep to the right, yielding right-of-way traffic, especially if pulling implements. Pull off the road and stop to allow motorists to pass. Drive on the road shoulder, if permitted by law.
6. Use extreme caution when pulling heavy loads at road speeds. Avoid hard application of the tractor brakes at high speed.
7. Always drive slowly near curbs, approaches or ditches.
8. If equipped, ensure headlights are aligned so they will not blind the operators of oncoming vehicles. If the tractor is not equipped with turn signals and law requires them, install them prior to operating on or near public roads.
9. Use your turn signals, checking for traffic well in advance of turning. If the tractor is not equipped with turn signals and law requires them, install them prior to operating on or near public roads.

Safety Decals

1. Keep decals clean. Remove dirt with a wet clean cloth when necessary.
2. Replace safety decals if destroyed, missing, painted over or unreadable. If any safety decals are covered or obscured when the ROPS is mounted, it is recommended that you purchase replacement decals from the tractor manufacturer. Mount them in a readable location at, or near, their original location before operating the tractor.
3. New ROPS decals and tractor decals are available from your tractor dealer.

ROPS Safety

1. Install the ROPS in accordance with Tektite mounting instructions. Failure to do so may affect the ROPS ability to withstand a roll over.
2. If the ROPS is subjected to alteration, structural damage or involved in an over turn accident, the entire structure must be replaced. Failure to do so may result in injury or death in the event of a roll over.
3. If the tractor is not equipped with seat belts, purchase approved seat belts from the tractor manufacturer or Tektite prior to operating the tractor.
4. Always fasten seat belts prior to operating the tractor.
5. Always operate the tractor from the operator's seat.
6. Remove mud, crop residue, chains and tools from steps and operator's platform. They may interfere with pedal operation or entry/exit from the tractor.
7. Remove all loose chains, tools, and equipment from the operator's platform. Failure to do so may cause injury or death in the event of a roll over.
8. Do not install the ROPS on a tractor model that the ROPS is not designated for (compatible tractor designations are printed on the ROPS serial number plate). The ROPS is designed specifically for individual models to ensure ROPS requirements will be met. Installing the ROPS on a non designated tractor may result in injury or death.

Emergency Exits

The ROPS cab has two doors. Either one can be used during an emergency.

Operating Instructions

Important

The following section locates, identifies and briefly describes the functions of all cab controls. All operators should familiarize themselves with control location and function prior to operating the utility vehicle. Failure to do so may result in unsafe operation of the utility vehicle and possible injury or death to operators and bystanders.

There are two switch plates located in the headliner. The following switches are available, and their functionality is described.

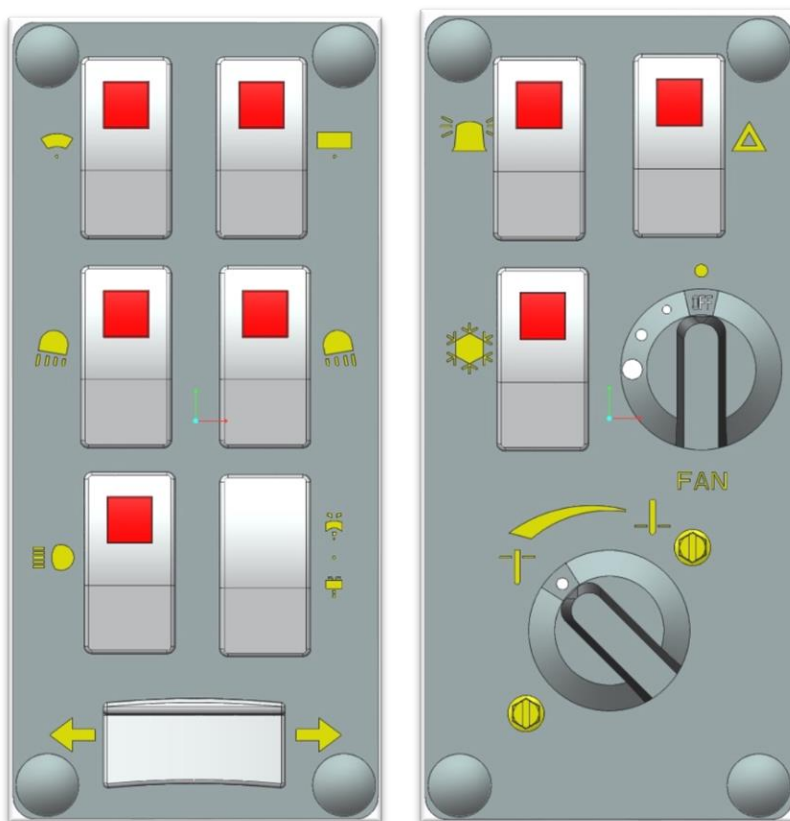

Left Switch Plate

1. Front Wiper Rocker Switch (standard)

Low position: Off

High position: On

Note: indicator light activates when wiper is on.

2. Rear Wiper Rocker Switch (optional)

Low position: Off

High position: On

Note: indicator light activates when wiper is on.

3. Front Work Light Rocker Switch (optional)

Low position: Off

High position: On

Note: indicator light activates when work lights are on.

4. Rear Work Light Rocker Switch (optional)

Low position: Off

High position: On

Note: indicator light activates when work light is on.

5. Head Lights Rocker Switch (optional)

Low position: Off

High position: On

Note: indicator light activates when head lights are on.

6. Front and Rear Washer Rocker Switch (optional)

Low position: Momentary – On Rear Washer

Middle position: Off

High position: Momentary – On Front Washer

7. Turn Signal Rocker Switch (optional)

Left position: On

Middle position: Off

Right position: On

Right Switch Plate**1. Beacon Rocker Switch (optional)**

Low position: Off

High position: On

Note: indicator light activates when beacon is on.

2. Hazard Rocker Switch (optional)

Low position: Off

High position: On

Note: indicator light activates when 4-way flashers are on.

3. Air Conditioner Rocker Switch (optional 2030A Only)

Low position: Off

High position: On

Note: indicator light activates when air conditioner is on.

4. Fan Rotary Switch (optional)

Indicator mark above switch indicates whether fan is operational or not.

5. Temperature Control Rotary Switch [Water Valve] (optional)

Indicator mark at lower left corner indicates current temperature setting. Rotate to increase heat output or to decrease heat output of heating system. When air conditioner is being used, it is recommended that the switch be at maximum cooling position.

Cab Circuit Protection

The Tektite ROPS cab is wired to provide maximum protection against accidental battery rundown and circuit overload. A relay in the cab is ignition activated and prevents the operator from accidentally leaving fan motors, lights on after turning the tractor off and leaving for the day. A circuit breaker is provided to prevent the cab electrical components from drawing more power than they should be able to from a dead short. The cab electrical components are also fused individually, and the fuse block is located in the headliner, directly above the door opening on the left side. Locate the 3" snap cap, and with a small flat screw driver you can remove the cap to examine the fuses provided. A decal on the fuse block indicates which fuse is for which electrical option.

John Deere ProGator ROPS Cab

The John Deere ProGator ROPS Cab is designed to provide ROPS protection along with reasonable winter weather protection. The cab design for this model features glass windows at all window locations.

If you are going to be running the tractor with the cab on during the summer months and you don't have the air conditioning option, un-hook the gas shocks on each door, and then lift the doors off of the pin hinges.

After your ROPS Cab has been installed:

Before starting a utility vehicle equipped with a Tektite ROPS cab:

1. Clear the operator platform of all tools. Tools left in or around the ROPS and utility vehicle can cause operator interference which could lead to bodily injury and/or damage the machine.
2. Inspect the ROPS and utility vehicle to ensure all bolts are tight and re-tighten if required.
3. Ensure that all pedals, levers, and controls have adequate clearance for normal operation.
4. Ensure that all electrical components of both the ROPS and utility vehicle operate normally.
5. Ensure your door latches properly onto the striker pin. Immediately after installation, the ROPS frame may flex slightly from installation, and the door latch will need to be re-aligned for proper operation. Loosen the striker pin, striker mounting plate and door latch as necessary to get a proper alignment of the door striker.

Service Parts Breakdowns:

Following are parts breakdowns for components that may require service parts replacement during the life of the ROPS. If you require replacement parts, please contact the dealer that you purchased the ROPS from and indicate which parts you require.

Index	Service Part #	File Name	Description	Qty
1	A00-0001	DLP-HANDLE	Outside Push Button Handle	1
2	A00-0003	RIGHT-LATCH	Suicide Door Right Latch	1
3	A00-0013	TEKT-0009	5MM Bushing	15
4	A00-0018	STEP-BOLT1-4X1-1-2	Step Bolt, 1/4" x 1 1/2", MB	3
5	A00-0020	STEP-BOLT1-4X1-1-4	Step Bolt, 1/4" x 1 1/4", MB	4
6	A00-0021	FLANGE-NUT-1-4	Flange Nut, 1/4", YD	9
7	A00-0022	FLANGE_BOLT_M6X25	Flange Bolt, M6x25, YD	1
8	A00-0041	TEKTITE-DECAL	Tektite Cab Decal - Solid White	1
9	A00-0042	TEKT-ASM-001R	Right Cab Door Hinge Weldment, Upper	1
10	A00-0118	FLANGE_BOLT_1-4X1	Flange Bolt, 1/4" x 1", YD	2
11	A00-0177	TEKT-0068	Handle Washer Spacer	1
12	A00-0229	TEKT-ASM-029R	Right Door Hinge Weldment, Lower	1
13	J10-0003	JDPROGATOR-025	Door Glass	1
14	J10-0007	JDPROGATOR-054R	Door Weatherseal	1
15	J10-0008	JDPROGATOR-053	Grab Handle	1
16	J10-0009	JDPROGATOR-ASM-09_RT	Right Door Frame Weldment	1

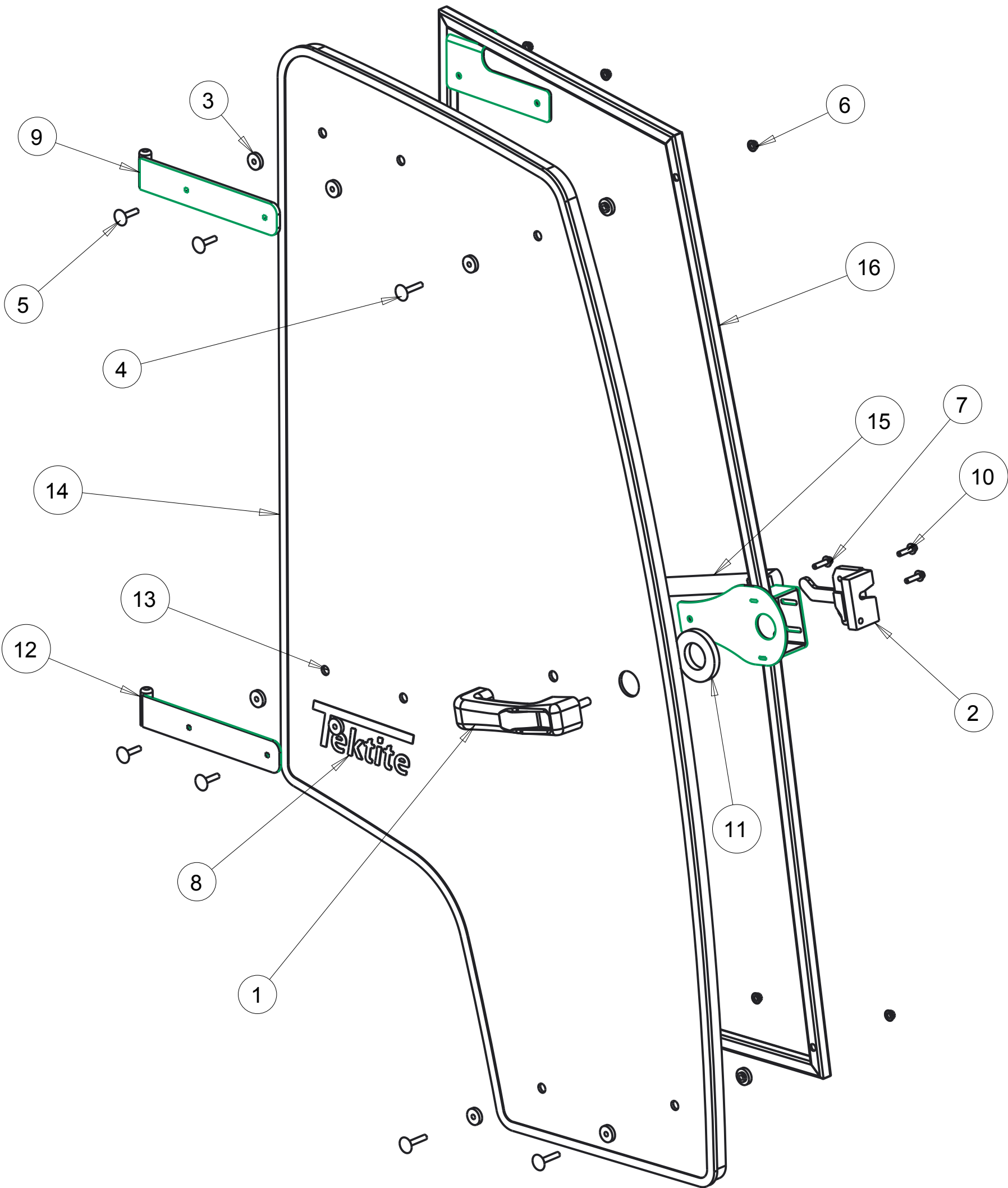

Notice of Confidentiality

This material is property of Tektite Manufacturing Inc and is not to be used by the recipient for any purpose other than the purpose for which it was transmitted. The material remains the property of Tektite and shall be returned upon request. The material may not be reproduced or disclosed to third parties without the written consent of Tektite.

Tolerances:
Unless otherwise specified
X.X = $\pm 1/16"$
Angular = $\pm 1.0^\circ$

Tektite Manufacturing Inc. 24157 Hwy 3, Box 639, Winkler MB, R6W 4A8, Canada				
Req'd:	CNC:	Description: Right Door Assembly		
Drawn By: <i>Daryl Furkalo</i>	Date: 2013-09-23	Units: Imp.	File Name: JDPROGATOR-ASM-08_RT_OP	
Checked By:	Date:	Size: B		

Index	Service Part #	File Name	Description	Qty
1	A00-0001	DLP-HANDLE	Outside Push Button Handle	1
2	A00-0002	LEFT-LATCH	Suicide Door Left Latch	1
3	A00-0013	TEKT-0009	5MM Bushing	15
4	A00-0018	STEP-BOLT1-4X1-1-2	Step Bolt, 1/4" x 1 1/2", MB	3
5	A00-0020	STEP-BOLT1-4X1-1-4	Step Bolt, 1/4" x 1 1/4", MB	4
6	A00-0021	FLANGE-NUT-1-4	Flange Nut, 1/4", YD	9
7	A00-0022	FLANGE_BOLT_M6X25	Flange Bolt, M6x25, YD	1
8	A00-0039	TEKT-ASM-001	Left Door Hinge Weldment, Upper	1
9	A00-0041	TEKTITE-DECAL	Tektite Cab Decal - Solid White	1
10	A00-0118	FLANGE_BOLT_1-4X1	Flange Bolt, 1/4" x 1", YD	2
11	A00-0177	TEKT-0068	Handle Washer Spacer	1
12	A00-0228	TEKT-ASM-029	Left Door Hinge Weldment, Lower	1
13	J10-0003	JDPROGATOR-025	Door Glass	1
14	J10-0007	JDPROGATOR-054	Door Weatherseal	1
15	J10-0008	JDPROGATOR-053	Grab Handle	1
16	J10-0010	JDPROGATOR-ASM-09	Left Door Frame Weldment	1

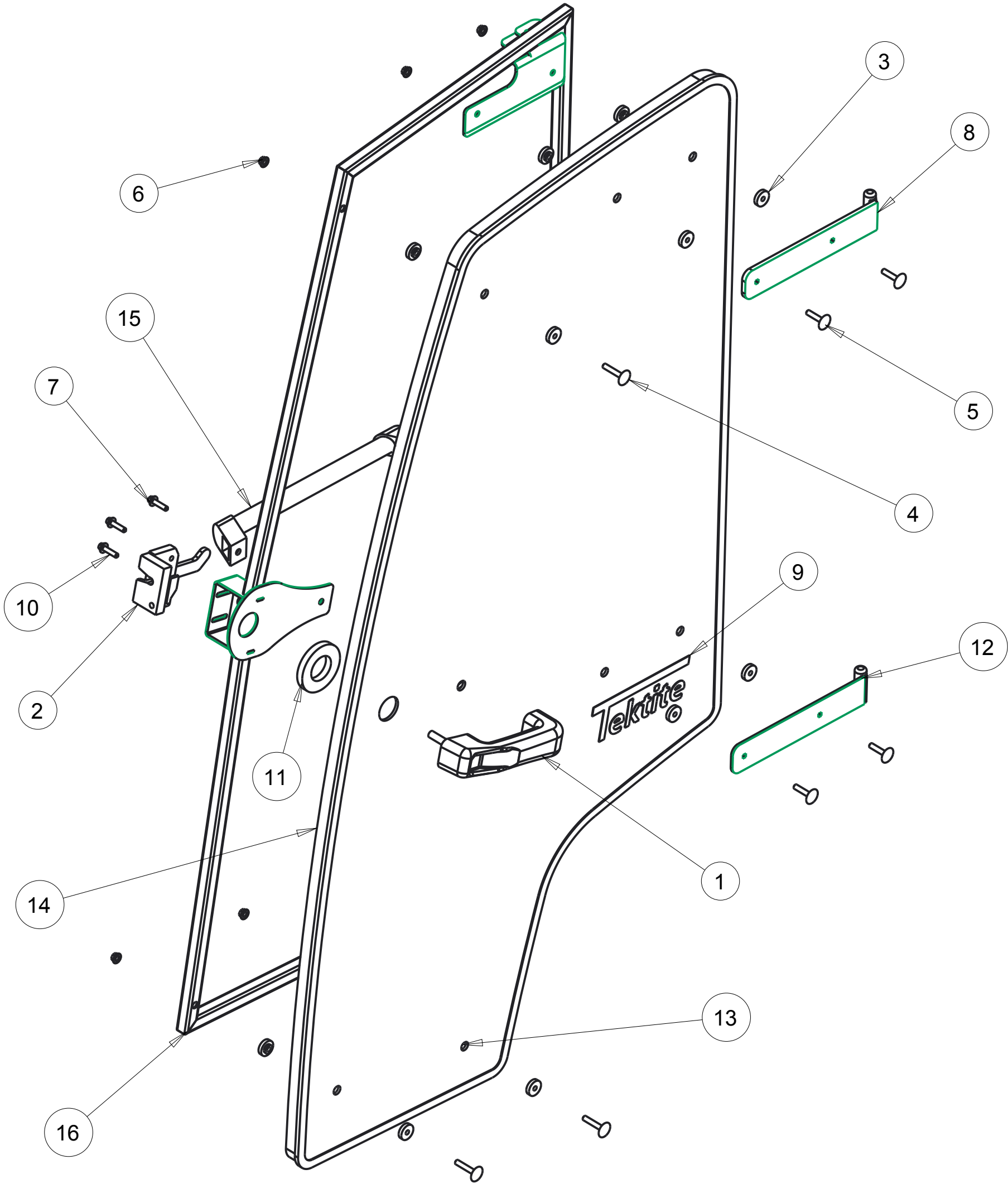

Notice of Confidentiality

This material is property of Tektite Manufacturing Inc and is not to be used by the recipient for any purpose other than the purpose for which it was transmitted. The material remains the property of Tektite and shall be returned upon request. The material may not be reproduced or disclosed to third parties without the written consent of Tektite.

Tolerances:
Unless otherwise specified
X.X = $\pm 1/16"$
Angular = $\pm 1.0^\circ$

Tektite Manufacturing Inc. 24157 Hwy 3, Box 639, Winkler MB, R6W 4A8, Canada					
Req'd:	CNC:	Description: Left Door Glass Assembly			
Drawn By: Daryl Furkalo	Date: 2013-09-23	Units: Imp.	File Name: JDPROGATOR-ASM-08_OP		
Checked By:	Date:	Size: B			

Index	Service Part #	File Name	Description	Qty
1	A00-0013	TEKT-0009	5MM Bushing	7
2	A00-0014	THICK-BUSHING	8MM Bushing	6
3	A00-0019	STEP-BOLT1-4X1	Step Bolt, 1/4" x 1", MB	1
4	A00-0020	STEP-BOLT1-4X1-1-4	Step Bolt, 1/4" x 1 1/4", MB	6
5	A00-0021	FLANGE-NUT-1-4	Flange Nut, 1/4", YD	7
6	A00-0033	315-080	Rear Wiper Shaft Grommet	1
7	A00-0036	245-044	1/2" Plug Button	1
8	A00-0037	245-046	1" Plug Button	1
9	A00-0043	WWF-MOTOR	WWF Wiper Motor, 1" Shaft	1
10	A00-0463	TEKT-ASM-069	Wiper Blade, 12", 2020, J-Hooko	1
11	A00-0583	TEKT-ASM-100	WWF, Adjustable Radial Arm, J-Hook, Short	1
12	J10-0003	JDPROGATOR-057	Windshield Seal	1
13	J10-0022	JDPROGATOR-078	Front Window Glass, 2 Wiper	1

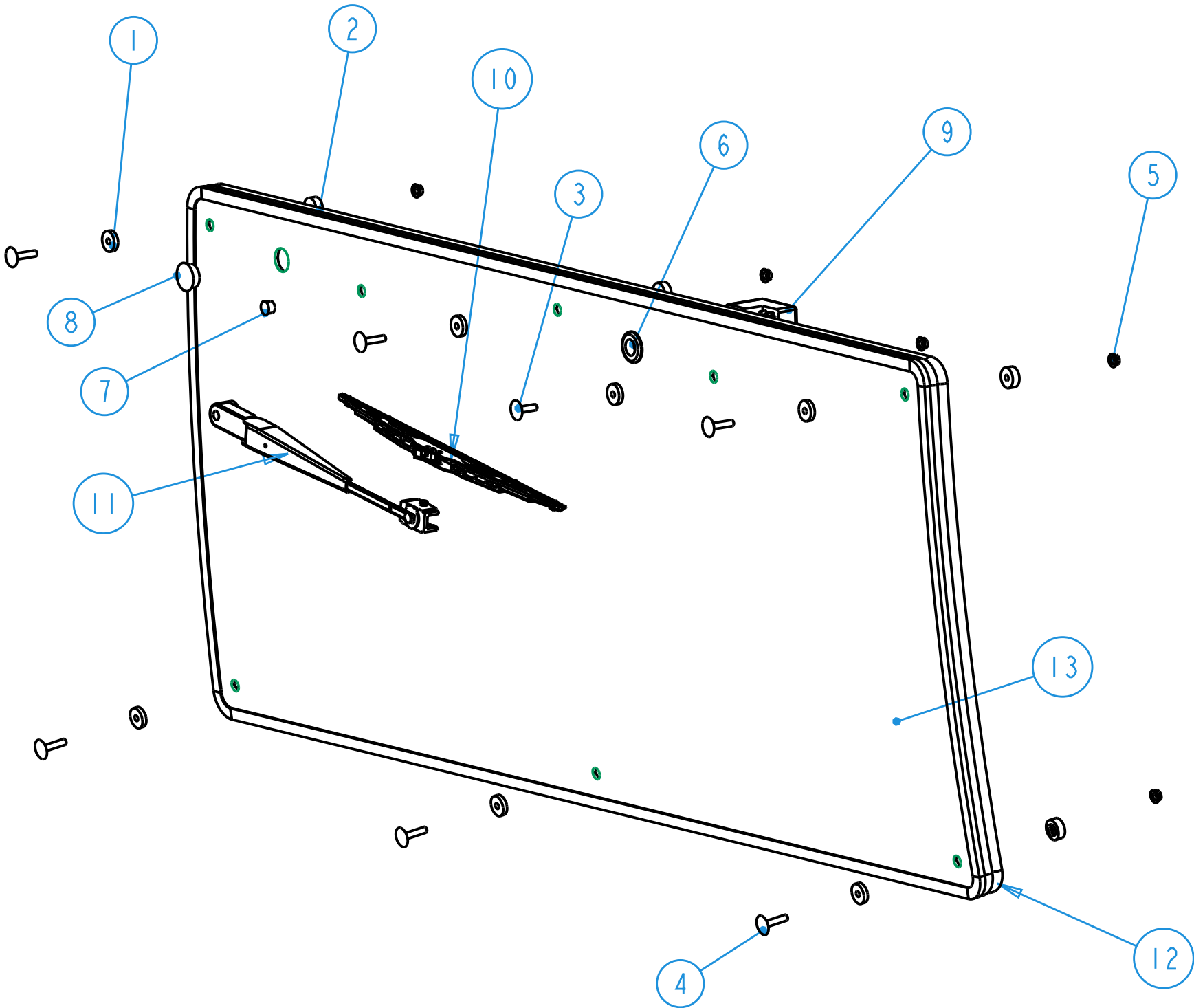

Notice of Confidentiality

This material is property of Tektite Manufacturing Inc and is not to be used by the recipient for any purpose other than the purpose for which it was transmitted. The material remains the property of Tektite and shall be returned upon request. The material may not be reproduced or disclosed to third parties without the written consent of Tektite.

Tolerances:
Unless otherwise specified
X.X = ±1/16"
Angular = ± 1.0°

Tektite Manufacturing Inc. 427 Buffalo Str, Box 639, Winkler MB, R6W 4A8, Canada				
Req'd:	CNC:	Description:		
1 req		Windshield Assembly		
Drawn By:	Date:	Units:	File Name:	
Daryl Furkalo	2025-03-25	Imp.	JDPROGATOR-ASM-15_NEW-OP	
Checked By:	Date:	Size:		
		B		

Index	Service Part #	File Name	Description	Qty
1	A00-0013	TEKT-0009	5MM Bushing	8
2	A00-0019	STEP-BOLT1-4X1	Step Bolt, 1/4" x 1", MB	4
3	A00-0021	FLANGE-NUT-1-4	Flange Nut, 1/4", YD	4
4	A00-0045	TEKT-0004	Side Window Slider Bracket	1
5	A00-0046	TEKT-ASM-002R	Side Window Hinge Right	2
6	A00-0056	TEKT-0020	Side Window Latch, L60775	1
7	A00-0058	CARRIAGE_BOLT-5-16X1	Bolt, Carriage, 5/16"x 1", YD	1
8	A00-0059	FLANGE-NUT-5-16	Flange Nut, 5/16", YD	1
9	A00-0119	WASHER_1-4	Washer, Flat, 1/4"	2
10	J10-0004	JDPROGATOR-026	Side Window Glass	1
11	J10-0012	JDPROGATOR-056R	Side Window Weather Seal	1

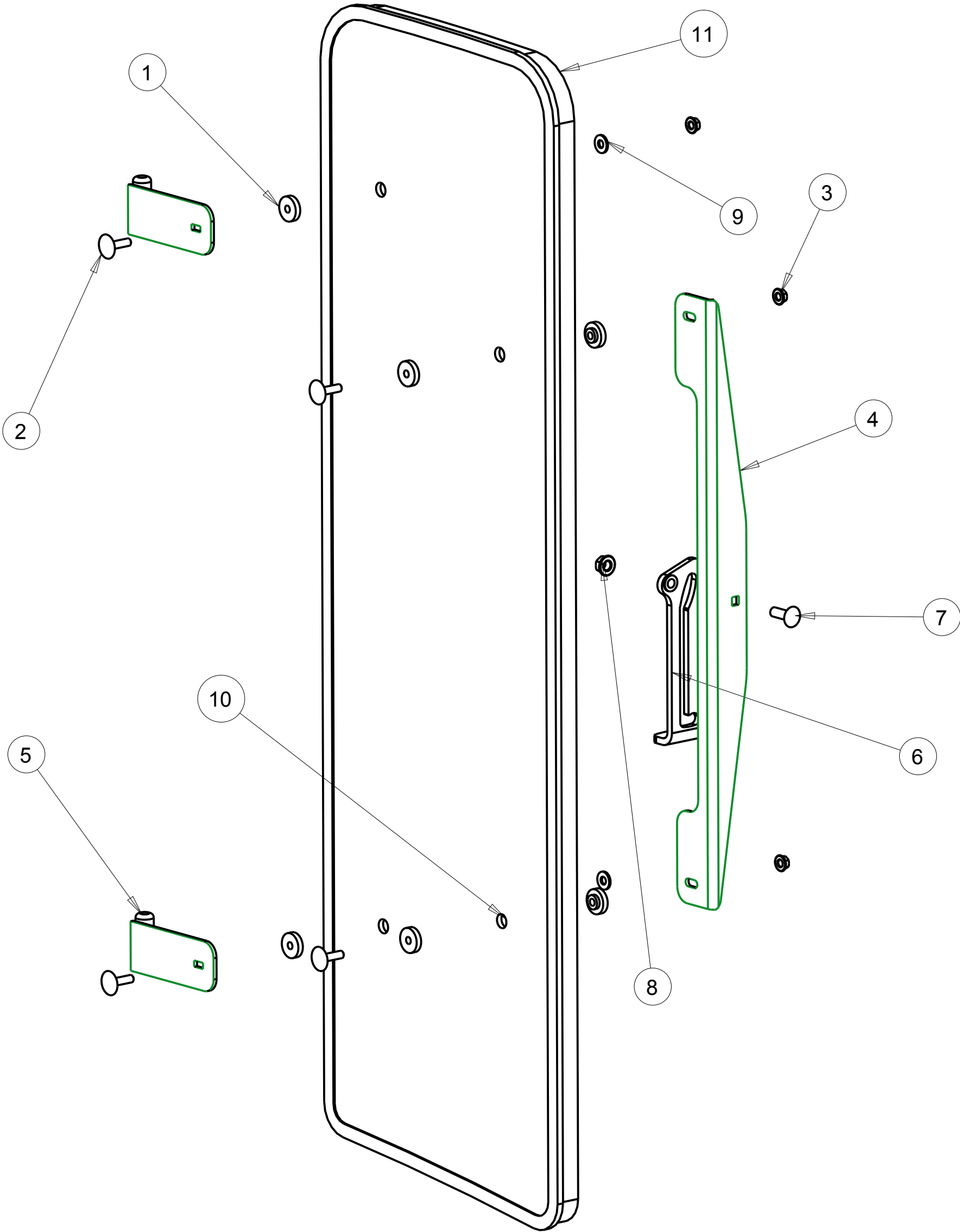

Notice of Confidentiality

This material is property of Tektite Manufacturing Inc and is not to be used by the recipient for any purpose other than the purpose for which it was transmitted. The material remains the property of Tektite and shall be returned upon request. The material may not be reproduced or disclosed to third parties without the written consent of Tektite.

Tolerances:
Unless otherwise specified
X.X = ± 1/16"
Angular = ± 1.0 °

Tektite Manufacturing Inc. 24157 Hwy 3, Box 639, Winkler MB, R6W 4A8, Canada				
Req'd:	CNC:	Description: Right Side Window Assembly		
Drawn By: Daryl Furkalo	Date: 2011-04-15	Units: Imp.	File Name: JDPROGATOR-ASM-14_OP	
Checked By:	Date:	Size: B		

Index	Service Part #	File Name	Description	Qty
1	A00-0013	TEKT-0009	5MM Bushing	8
2	A00-0019	STEP-BOLT1-4X1	Step Bolt, 1/4" x 1", MB	4
3	A00-0021	FLANGE-NUT-1-4	Flange Nut, 1/4", YD	4
4	A00-0044	TEKT-ASM-002	Side Window Hinge Weldment	2
5	A00-0045	TEKT-0004	Side Window Slider Bracket	1
6	A00-0057	TEKT-0020MIR	Side Window Latch, L60776	1
7	A00-0058	CARRIAGE_BOLT-5-16X1	Bolt, Carriage, 5/16"x 1", YD	1
8	A00-0059	FLANGE-NUT-5-16	Flange Nut, 5/16", YD	1
9	A00-0119	WASHER_1-4	Washer, Flat, 1/4"	2
10	J10-0004	JDPROGATOR-026	Side Window Glass	1
11	J10-0012	JDPROGATOR-056	Side Window Weather Seal	1

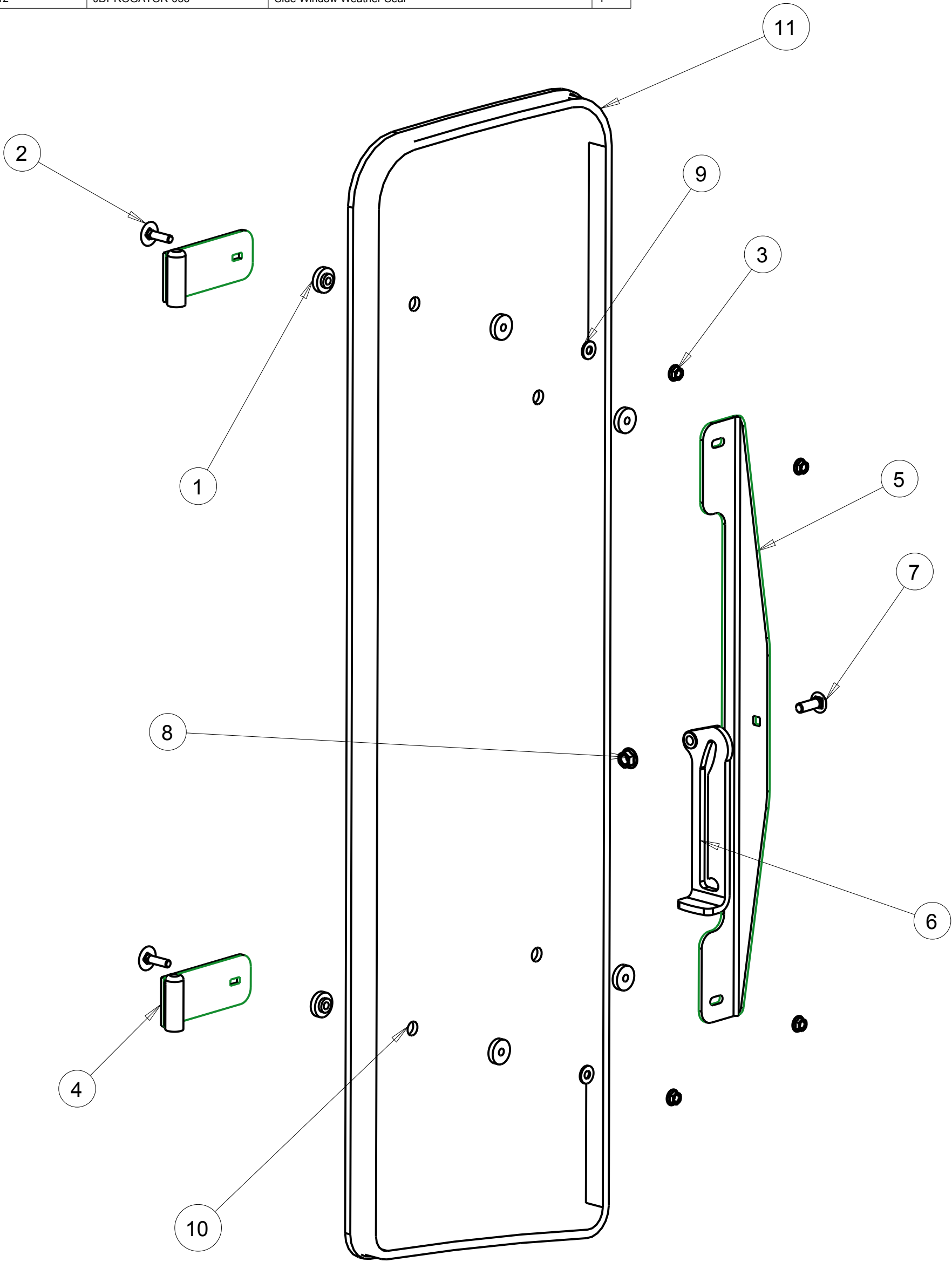

Notice of Confidentiality

This material is property of Tektite Manufacturing Inc and is not to be used by the recipient for any purpose other than the purpose for which it was transmitted. The material remains the property of Tektite and shall be returned upon request. The material may not be reproduced or disclosed to third parties without the written consent of Tektite.

Tolerances:
Unless otherwise specified
X.X = ± 1/16"
Angular = ± 1.0 °

Tektite Manufacturing Inc. 24157 Hwy 3, Box 639, Winkler MB, R6W 4A8, Canada				
Req'd:	CNC:	Description: Left Side Window Assembly		
Drawn By: Daryl Furkalo	Date: 2011-04-15	Units: Imp.	File Name: JDPROGATOR-ASM-13_OP	
Checked By:	Date:	Size: B		

Index	Service Part #	File Name	Description	Qty
1	A00-0013	TEKT-0009	5MM Bushing	12
2	A00-0014	THICK-BUSHING	8MM Bushing	6
3	A00-0020	STEP-BOLT1-4X1-1-4	Step Bolt, 1/4" x 1 1/4", MB	6
4	A00-0021	FLANGE-NUT-1-4	Flange Nut, 1/4", YD	6
5	J10-0001	JDPROGATOR-023	Rear Window Glass	1
6	J10-0011	JDPROGATOR-055	Rear Window Seal	1

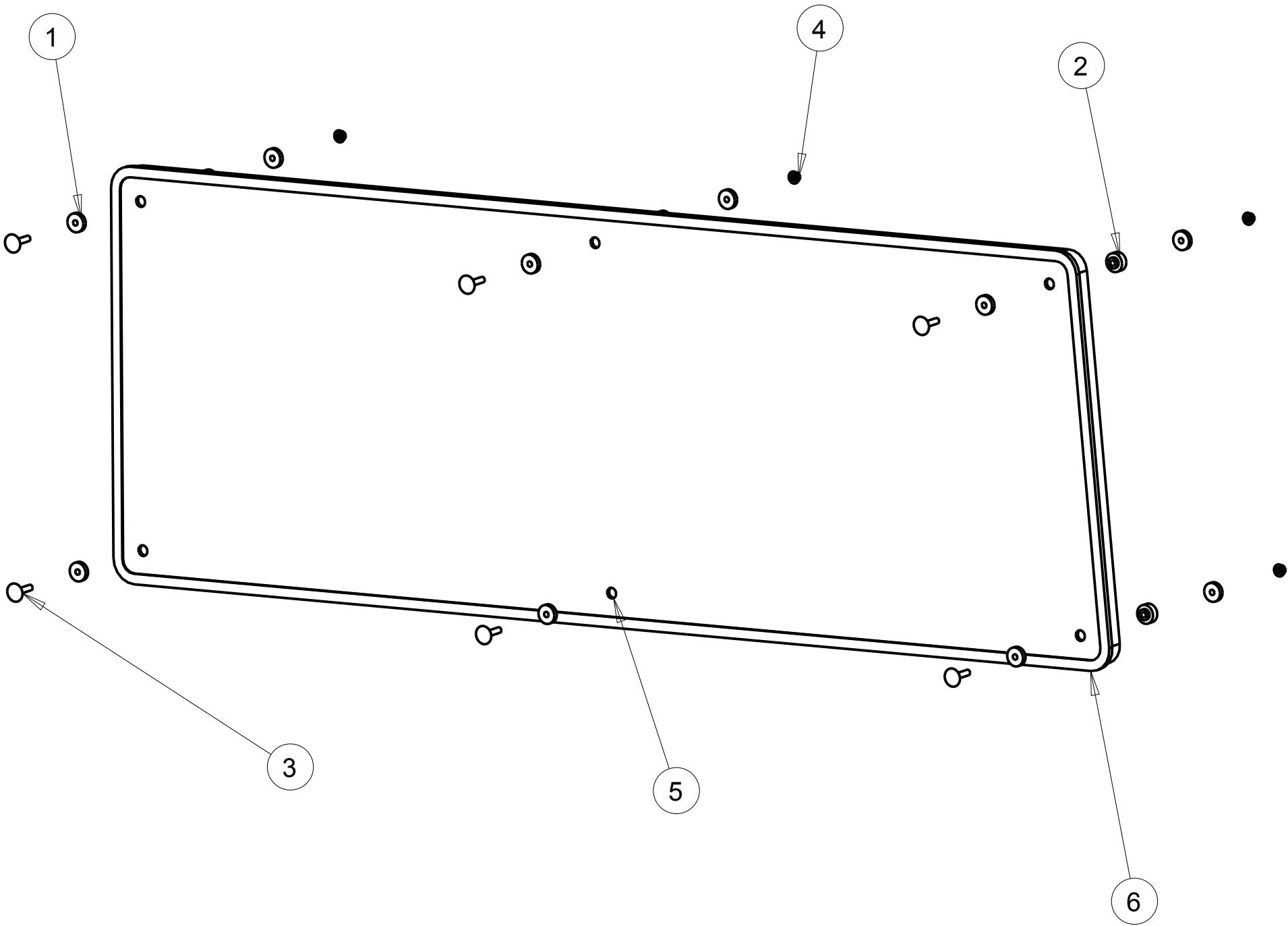

Notice of Confidentiality

This material is property of Tektite Manufacturing Inc and is not to be used by the recipient for any purpose other than the purpose for which it was transmitted. The material remains the property of Tektite and shall be returned upon request. The material may not be reproduced or disclosed to third parties without the written consent of Tektite.

Tolerances:
Unless otherwise specified
X.X = ± 1/16"
Angular = ± 1.0 °

Tektite Manufacturing Inc. 24157 Hwy 3, Box 639, Winkler MB, R6W 4A8, Canada				
Req'd:	CNC:	Description: Rear Window Assembly		
Drawn By: Daryl Furkalo	Date: 2011-04-13	Units: Imp.	File Name: JDPROGATOR-ASM-12_OP	
Checked By:	Date:	Size: B		

Index	Service Part #	File Name	Description	Qty
1	A00-0007	FAN-SWITCH	4-Position Fan Switch	1
2	A00-0053	TEKT-0017	Plastic Knob	2
3	A00-0065	TEKT-ASM-005	On-Off Switch w/Lens	3
4	A00-0252	TEKT-0117	Brass Water Valve	1
5	A00-0253	TEKT-0119	Right Switchplate Decal	1
6	A00-0282	SCREW-3-16X3-4	Screw, Self-Tap, 3/16" x 3/4"	2
7	A00-0283	TEKT-0118	Right Switchplate	1
8	A00-0354	SCREW-10-24X3-4	Screw, 10-24 x 3/4",MB	4

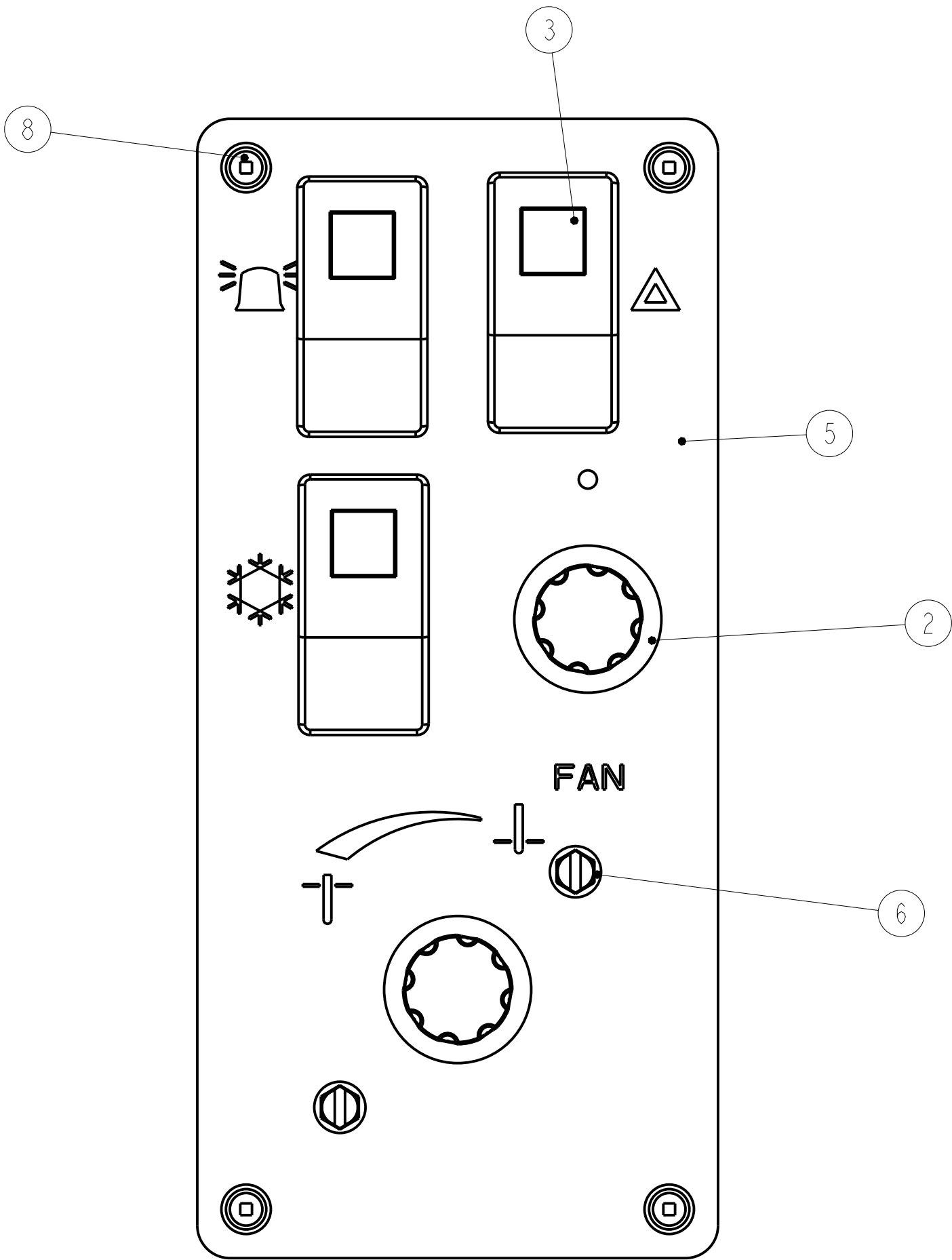

Notice of Confidentiality

This material is property of Tektite Manufacturing Inc and is not to be used by the recipient for any purpose other than the purpose for which it was transmitted. The material remains the property of Tektite and shall be returned upon request. The material may not be reproduced or disclosed to third parties without the written consent of Tektite.

Tolerances:
Unless otherwise specified
X.X = ±1/16"
Angular = ± 1.0°

Tektite Manufacturing Inc. 427 Buffalo Str, Box 639, Winkler MB, R6W 4A8, Canada				
Req'd:	CNC:	Description: New Valve Design Switch Plate, 2025		
Drawn By: Daryl Furkalo	Date: 2025-03-26	Units: Imp.	File Name: TEKT-ASM-030	
Checked By:	Date:	Size: B		

Index	Service Part #	File Name	Description	Qty
1		JDPROGATOR-ASM-78		1
2	A00-0055	TEKT-0019	Fir Tree Fastener	2
3	A00-0070	REID-KBP-262-KBP-265	Knob, Knurled, 1/4"	2
4	A00-0074	TEKT-ASM-004	Fuse Block Assembly	1
5	A00-0482	TEKT-ASM-076	Elbow Louvre	4
6	A00-0483	TEKT-ASM-080	Kalori, Heater/AC, 4-Outlet	1
7	J10-0006	JDPROGATOR-041	Outer Filter Cover	1
8	J10-0016	JDPROGATOR-077	Air Filter, Charcoal	1
9	J10-0025	JDPROGATOR-ASM-28	Fuse Block Cover Assembly	1
10	J10-0060	JDPROGATOR-ASM-75	Roof Cap, AC, 2023 Change	1

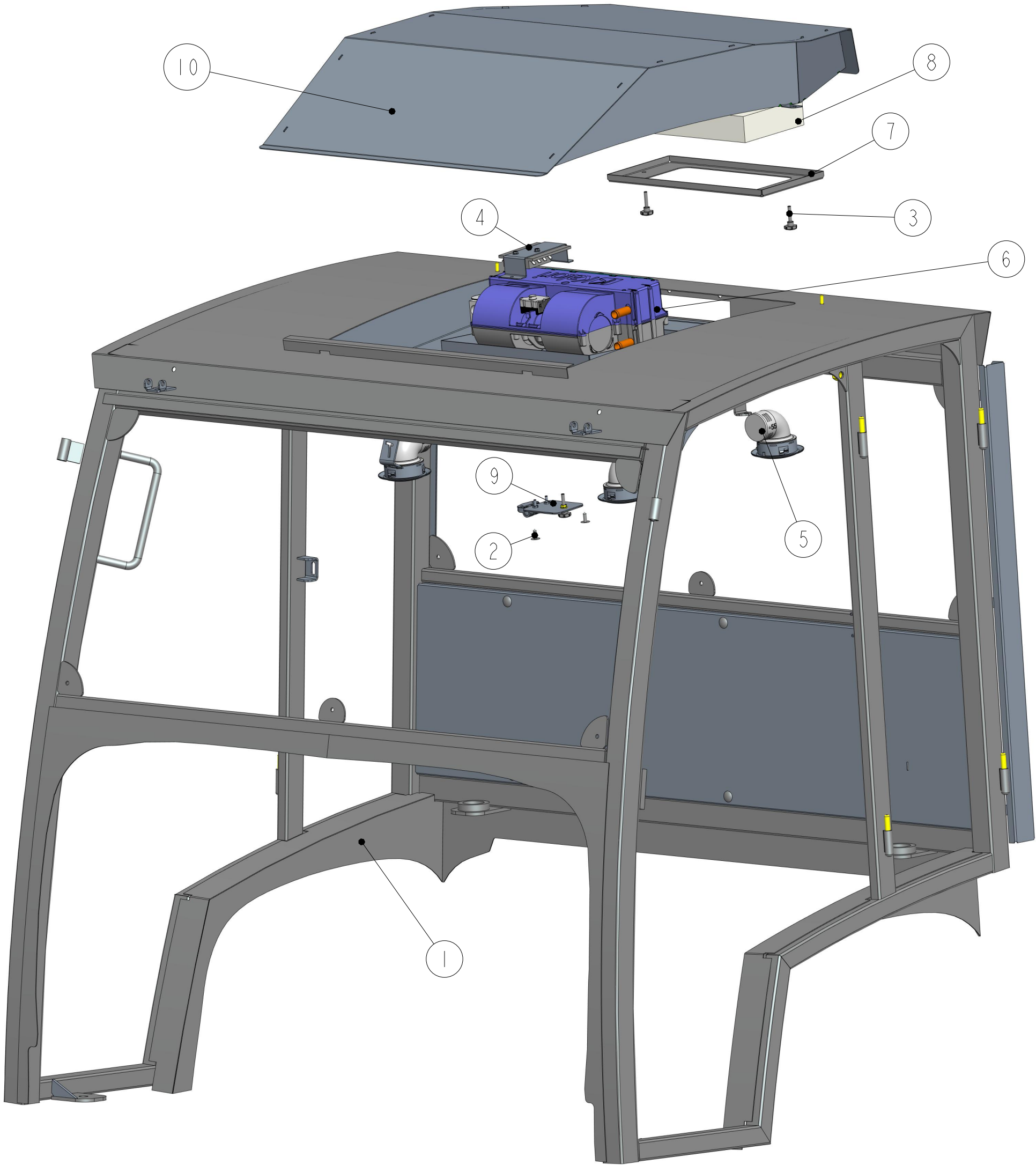

Tektite Manufacturing Inc.

427 Buffalo Str, Box 639, Winkler MB, R6W 4A8, Canada

Notice of Confidentiality

This material is property of Tektite Manufacturing Inc and is not to be used by the recipient for any purpose other than the purpose for which it was transmitted. The material remains the property of Tektite and shall be returned upon request. The material may not be reproduced or disclosed to third parties without the written consent of Tektite.

Tolerances:
Unless otherwise specified
X.X = ±1/16"
Angular = ± 1.0°

Req'd:	CNC:	Description: AC Components Assembly, Oct 2013	
Drawn By: <i>Daryl Furkalo</i>	Date: 2025-03-25	Units: Imp.	File Name: JDPROGATOR-ASM-37
Checked By:	Date:	Size: B	

Index	Service Part #	File Name	Description	Qty
1	A00-0166	TEKT-0103	Condensor Fan	2
2	A00-0220	TEKT-0101	Base Condenser Coil	1
3	A00-0221	TEKT-0102	Condensor Assembly Steel Shroud	1

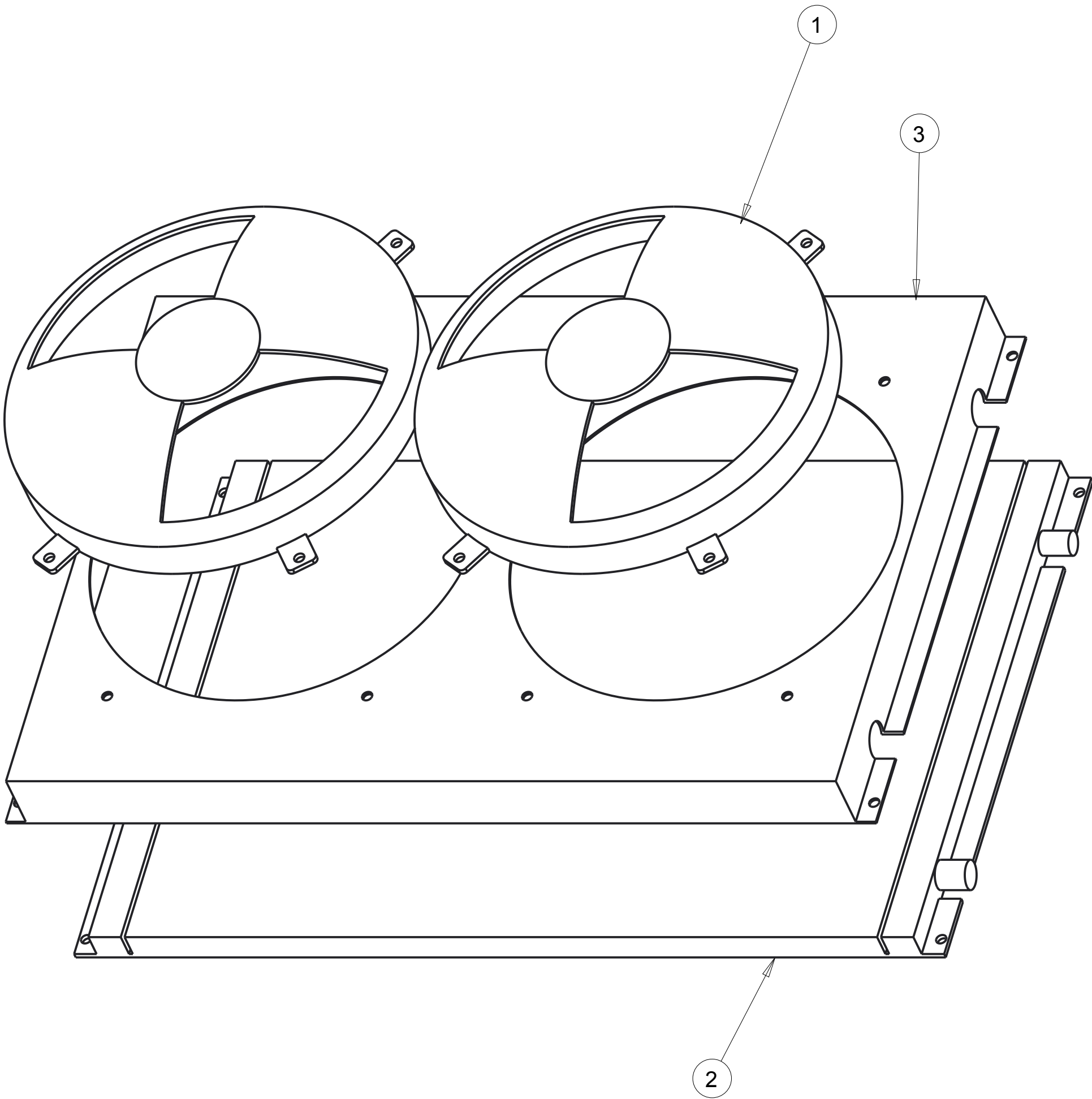

Notice of Confidentiality

This material is property of Tektite Manufacturing Inc and is not to be used by the recipient for any purpose other than the purpose for which it was transmitted. The material remains the property of Tektite and shall be returned upon request. The material may not be reproduced or disclosed to third parties without the written consent of Tektite.

Tolerances:
Unless otherwise specified

X.X = ± 1/16"
Angular = ± 1.0°

Tektite Manufacturing Inc. 24157 Hwy 3, Box 639, Winkler MB, R6W 4A8, Canada					
Req'd:	CNC:	Description: Condensor Assembly Breakdown			
Drawn By: Daryl Furkalo	Date: 2013-07-04	Units: Imp.	File Name: TEKT-ASM-O26		
Checked By:	Date:	Size: B			

Index	Service Part #	File Name	Description	Qty
1	A00-0063	LEFT-CAB-SWITCHPLATE	Left Switchplate	1
2	A00-0064	LEFT-CAB-SWITCHPLATE-DECAL	Left Switchplate Decal	1
3	A00-0065	TEKT-ASM-005	On-Off Switch w/Lens	5
4	A00-0066	TEKT-ASM-006	On-Off-On Rocker No Lens	1
5	A00-0067	TEKT-ASM-007	Mom-Off-Mom Rocker Switch	1
6	A00-0354	SCREW-10-24X3-4	Screw, 10-24 x 3/4",MB	4

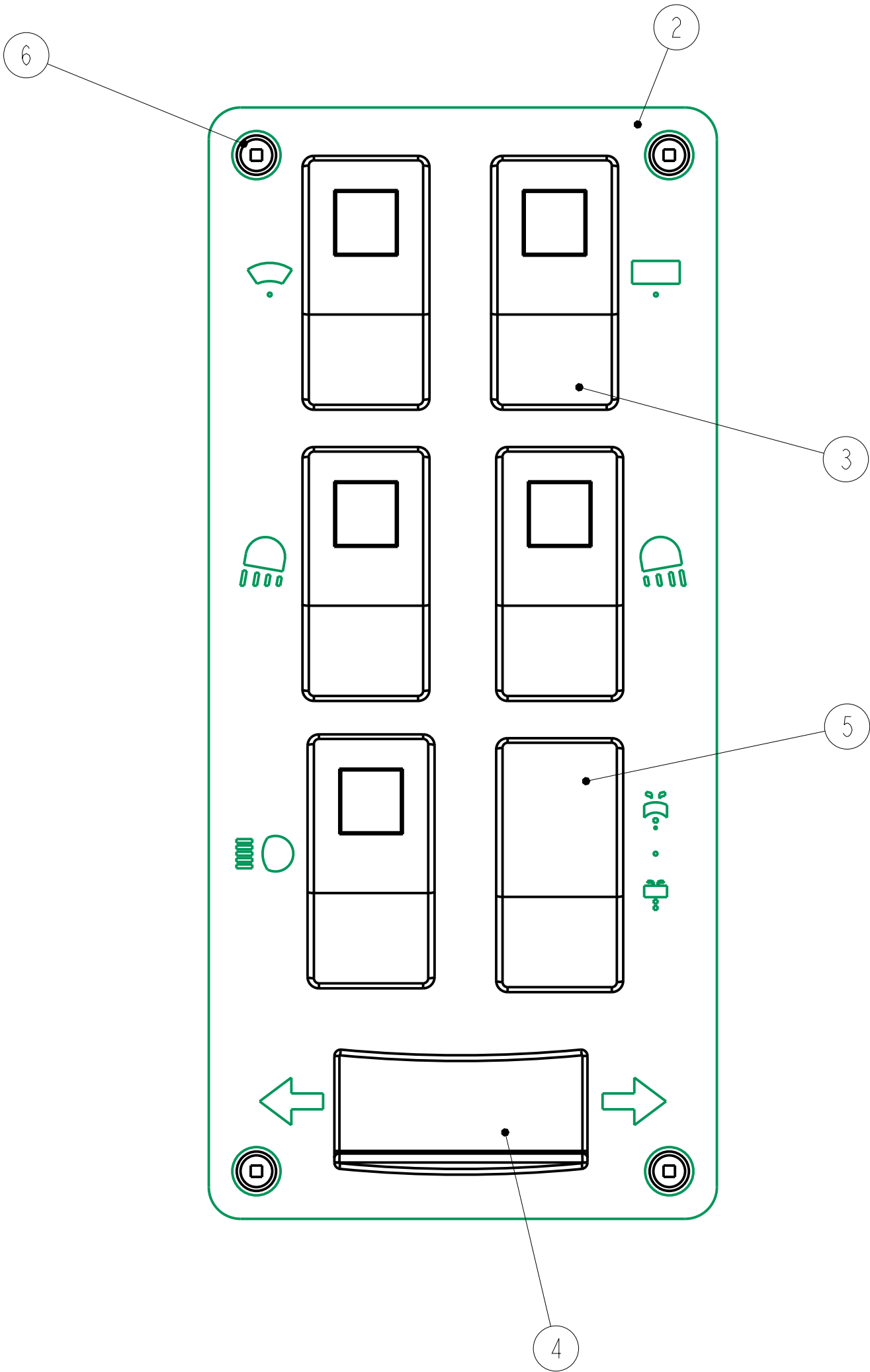

Notice of Confidentiality

This material is property of Tektite Manufacturing Inc and is not to be used by the recipient for any purpose other than the purpose for which it was transmitted. The material remains the property of Tektite and shall be returned upon request. The material may not be reproduced or disclosed to third parties without the written consent of Tektite.

Tolerances:
Unless otherwise specified
X.X = ±1/16"
Angular = ± 1.0°

Tektite Manufacturing Inc. 427 Buffalo Str, Box 639, Winkler MB, R6W 4A8, Canada				
Req'd: 1 req	CNC:	Description: LH Switchplate Update, 2025		
Drawn By: Daryl Furkalo	Date: 2025-03-26	Units: Imp.	File Name: TEKT-ASM-101	
Checked By:	Date:	Size: B		



Dryer to Evaporator Hose
Part # J10-0021

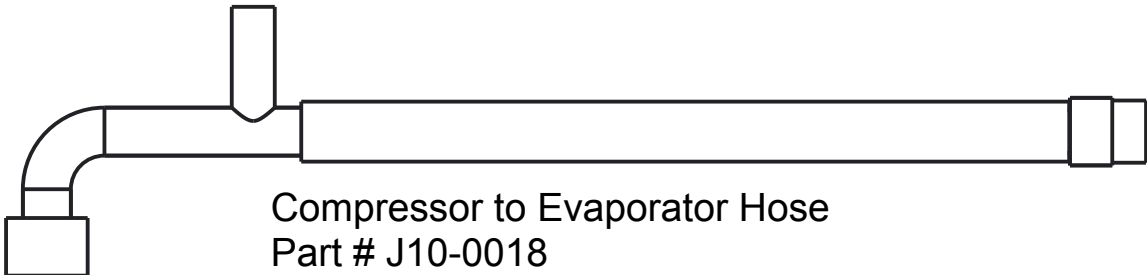

Compressor to Evaporator Hose
Part # J10-0018



Condenser to Dryer Hose
Part # J10-0020

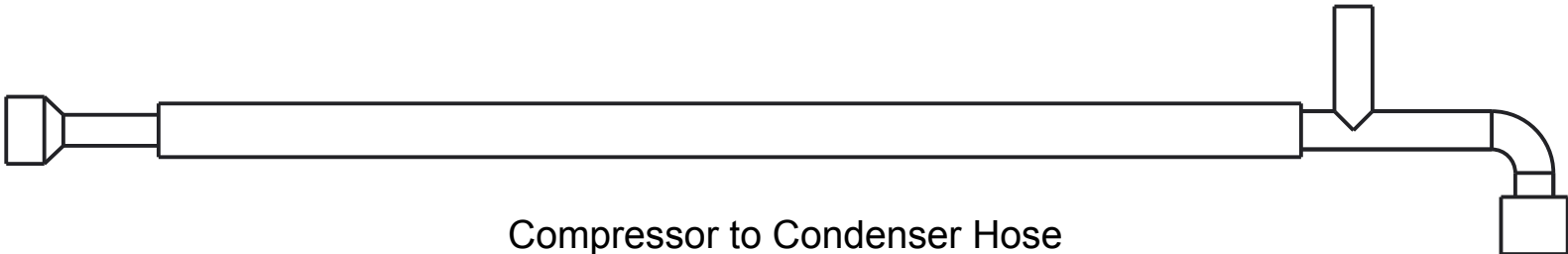

Compressor to Condenser Hose
Part # J10-0019

Notice of Confidentiality

This material is property of Tektite Manufacturing Inc and is not to be used by the recipient for any purpose other than the purpose for which it was transmitted. The material remains the property of Tektite and shall be returned upon request. The material may not be reproduced or disclosed to third parties without the written consent of Tektite.

Tolerances:
Unless otherwise specified
X.X = ± 1/16"
Angular = ± 1.0°

Tektite Manufacturing Inc. 24157 Hwy 3, Box 639, Winkler MB, R6W 4A8, Canada					
Req'd:	1 req	Description: A/C Hoses Breakdown			
Drawn By:	Daryl Furkalo	Date:	2013-05-29	Units:	Imp.
Checked By:		Date:		Size:	B

Index	Service Part #	File Name	Description	Qty
1		JDPROGATOR-ASM-81		1
2	A00-0006	TEKT-0074	Cabin Air Filter	2
3	A00-0055	TEKT-0019	Fir Tree Fastener	2
4	A00-0070	REID-KBP-262-KBP-265	Knob, Knurled, 1/4"	4
5	A00-0073	FILTER-COVER	Filter Cover	2
6	A00-0074	TEKT-ASM-004	Fuse Block Assembly	1
7	A00-0076	TEKT-0026	1/4" Panel Nut	4
8	A00-0481	TEKT-ASM-079	Heater, PT, May 2022	1
9	A00-0482	TEKT-ASM-076	Elbow Louvre	4
10	J10-0025	JDPROGATOR-ASM-28	Fuse Block Cover Assembly	1
11	J10-0040	JDPROGATOR-ASM-61	Roof Cap, Heater May 2016	1

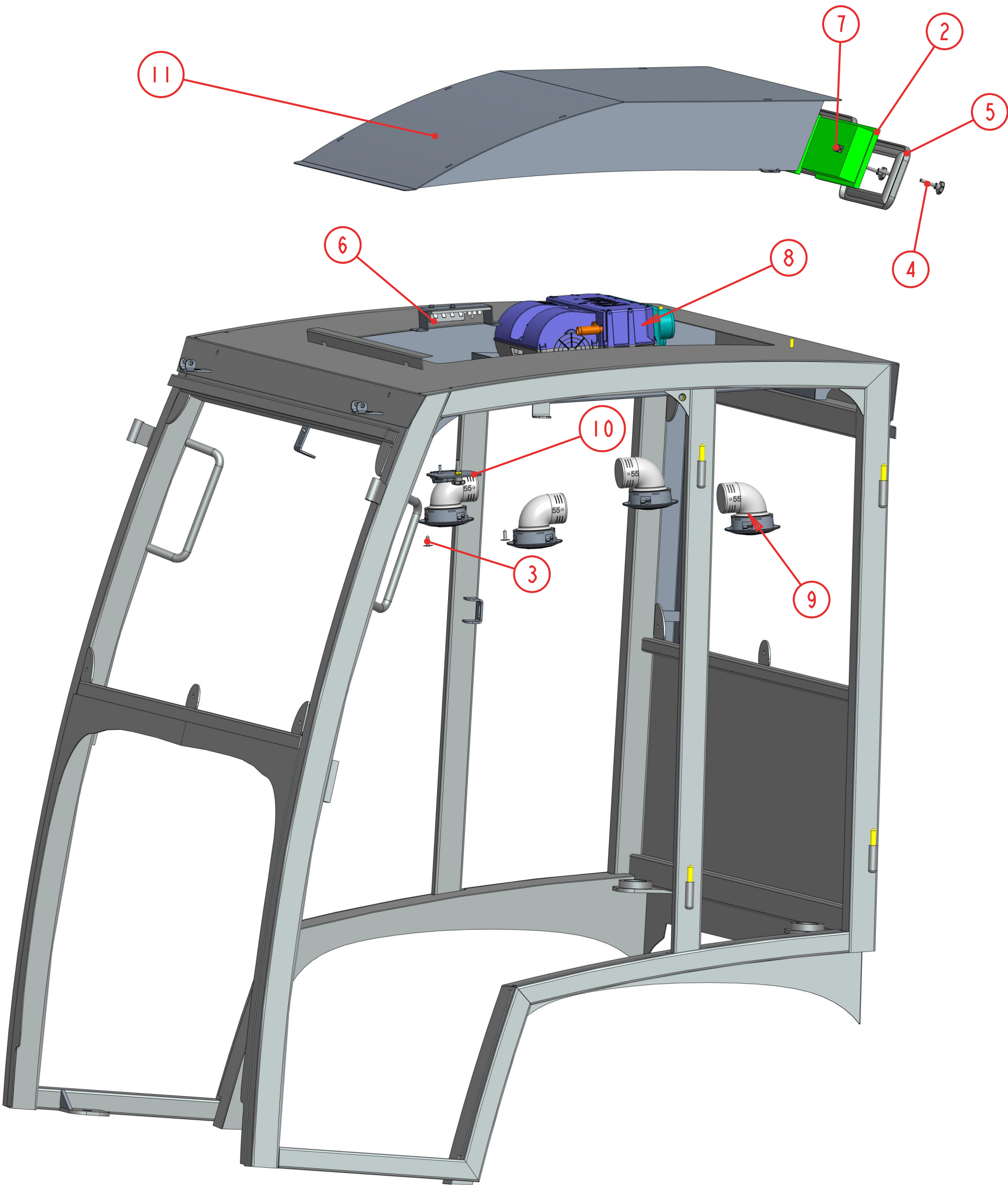

Tektite Manufacturing Inc.
427 Buffalo Str, Box 639, Winkler MB, R6W 4A8, Canada

Notice of Confidentiality

This material is property of Tektite Manufacturing Inc and is not to be used by the recipient for any purpose other than the purpose for which it was transmitted. The material remains the property of Tektite and shall be returned upon request. The material may not be reproduced or disclosed to third parties without the written consent of Tektite.

Tolerances:
Unless otherwise specified
X.X = ±1/16"
Angular = ± 1.0°

Req'd:	CNC:	Description:	
1 req		Heater Component Assembly, May 2016	
Drawn By:	Date:	Units:	File Name:
Daryl Furkalo	2025-03-25	Imp.	JDPROGATOR-ASM-38
Checked By:	Date:	Size:	
		B	

Index	Service Part #	File Name	Description	Qty
1		JDPROGATOR-ASM-81		1
2	A00-0023	FLANGE_BOLT_1-4X3-4	Flange Bolt, 1/4" x 3/4", YD	4
3	A00-0061	TEKT-0021	Striker Mounting Plate	2
4	A00-0084	TEKT-0070	Gas Shock	2
5	A00-0085	TEKT-0069	Gas Shock Stud	2
6	A00-0101	STRIKER-PIN	Striker Pin	2
7	A00-0103	HEX-NUT-M12X1	Hex Nut, M12 x 1.0, YD	2
8	A00-0371	TEKT-0175	New LED Work Light (Blazer Intl)	4
9	A00-0389	KUBX2380-NOSTRIL	Plastic Light Nostril	2
10	A00-0413	FLANGE-NUT-5-16	Flange Nut, 5/16", YD	2
11	A00-0519	TEKT-0244	Rectangular Mirror	2
12	A00-0520	TEKT-0243	Mirror Bracket Bar	2
13	A00-0521	M12X1.75-NYLOCK-NUT	Nylon Lock Nut, M12 x 1.75	3
14	A00-0535	TEKT-0249	Rectangular Interior Mirror	1
15	A00-0536	TEKT-0250	Spacer For Interior Mirror	1
16	A00-0537	CARRIAGE_BOLT_M12X50	Carriage Bolt, M12 x 50	1
17	A00-0552	M12X18-LOCK-NUT	M12 x 1.75 Crimp Lock Nut	2

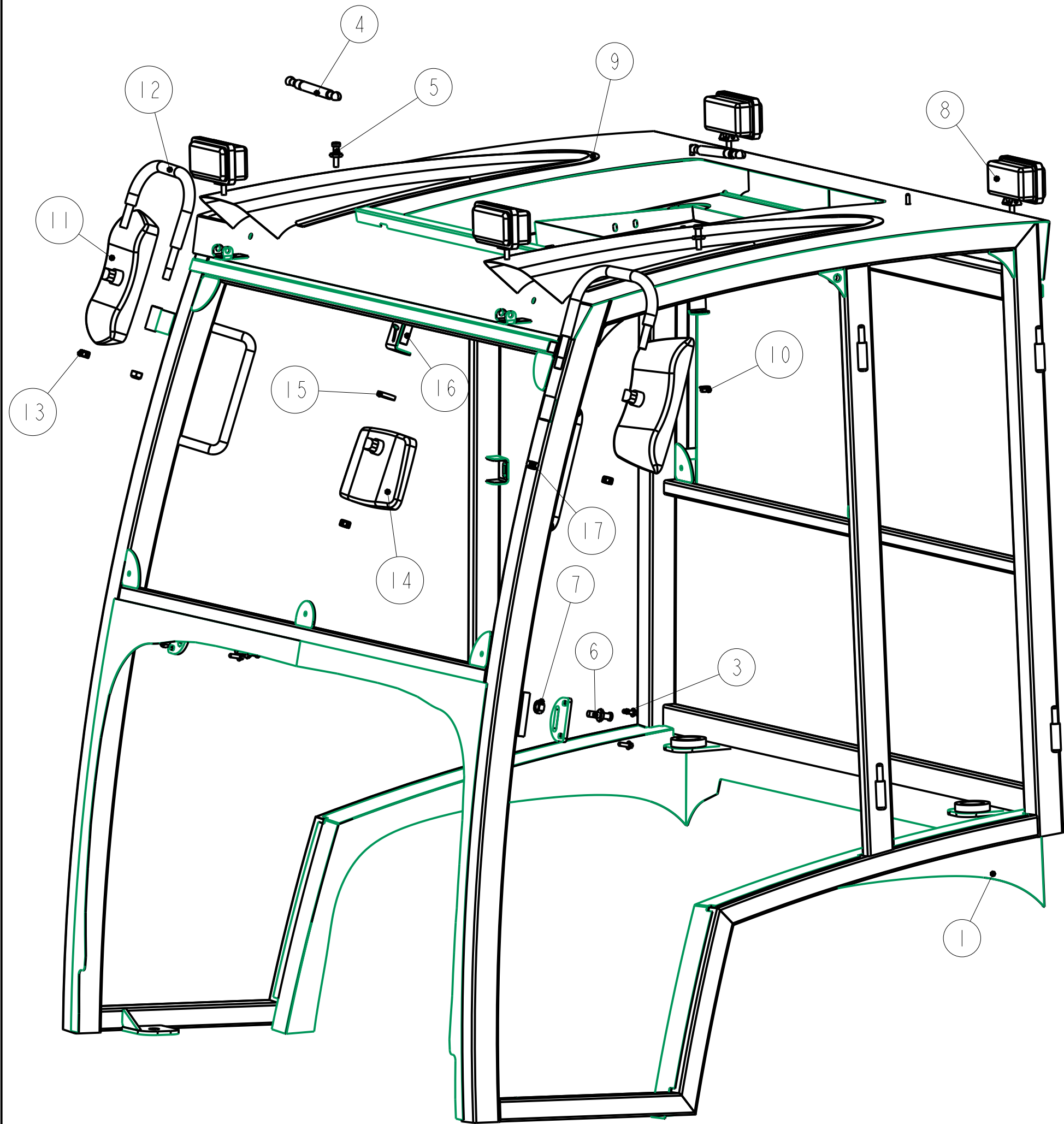

Tektite Manufacturing Inc.

427 Buffalo Str, Box 639, Winkler MB, R6W 4A8, Canada

Notice of Confidentiality

This material is property of Tektite Manufacturing Inc and is not to be used by the recipient for any purpose other than the purpose for which it was transmitted. The material remains the property of Tektite and shall be returned upon request. The material may not be reproduced or disclosed to third parties without the written consent of Tektite.

Tolerances:
Unless otherwise specified
X.X = ±1/16"
Angular = ± 1.0°

Req'd:		CNC:	Description: Cab Accessories	
Drawn By:	Date:	Units:	File Name:	
Daryl Furkalo	2025-03-26	Imp.	JDPROGATOR-ASM-34_OP	
Checked By:	Date:	Size:		
		B		

Index	Service Part #	File Name	Description	Qty
1		JDPROGATOR-ASM-55		1
2	A00-0281	WHELEN-LIGHT	Whelen Style Amber Flasher	4
3	A00-0285	FLANGE-NUT-NO6	Flange Nut, No 6	8
4	A00-0333	SOCKET-HEX-CAP-SCREW_NO6X3.4	Socket Head, Cap Screw, No 6 x 3.4"	8
5	A00-0371	TEKT-0175	New LED Work Light (Blazer Intl)	4

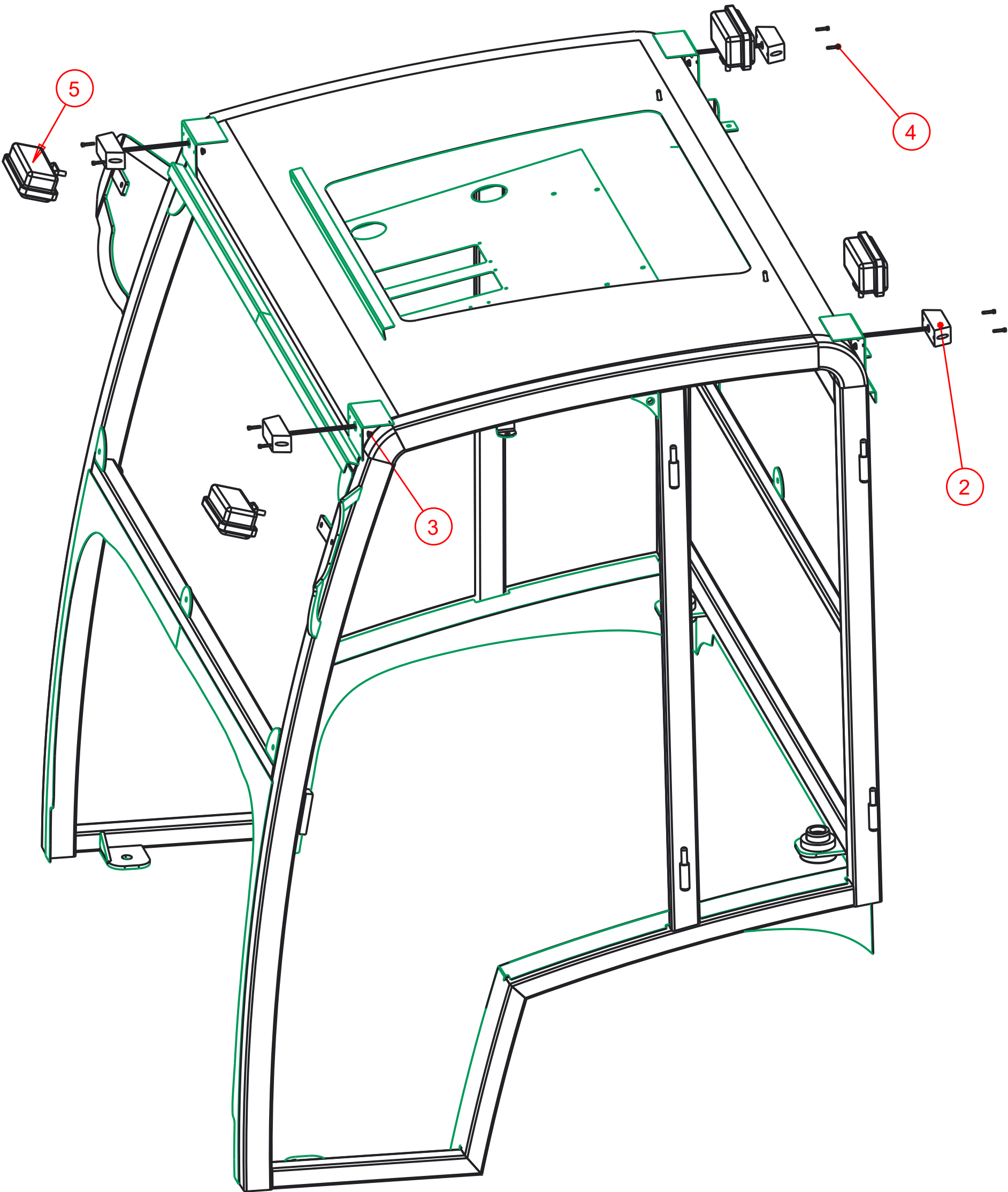

Notice of Confidentiality

This material is property of Tektite Manufacturing Inc and is not to be used by the recipient for any purpose other than the purpose for which it was transmitted. The material remains the property of Tektite and shall be returned upon request. The material may not be reproduced or disclosed to third parties without the written consent of Tektite.

Tolerances:
Unless otherwise specified

X.X = $\pm 1/16"$
Angular = $\pm 1.0^\circ$

Tektite Manufacturing Inc. 24157 Hwy 3, Box 639, Winkler MB, R6W 4A8, Canada				
Req'd:	CNC:	Description: New Lighting		
Drawn By: <i>Daryl Furkalo</i>	Date: 2016-11-23	Units: Imp.	File Name: JDPROGATOR-ASM-56	
Checked By:	Date:	Size: B		